

Line-No.	Date	27.02.2012	Order-No.		Amount		Supplier Laserpack Fryazino
	Path	aserpack/filesW	Author	Yashin A	Height		
	File	d> ECMA_A41...dds	Customer		Manufacturer		
	Holz 10/15/18		Line type		Material		
	Sonstiges		Pointage		Mat. Table		

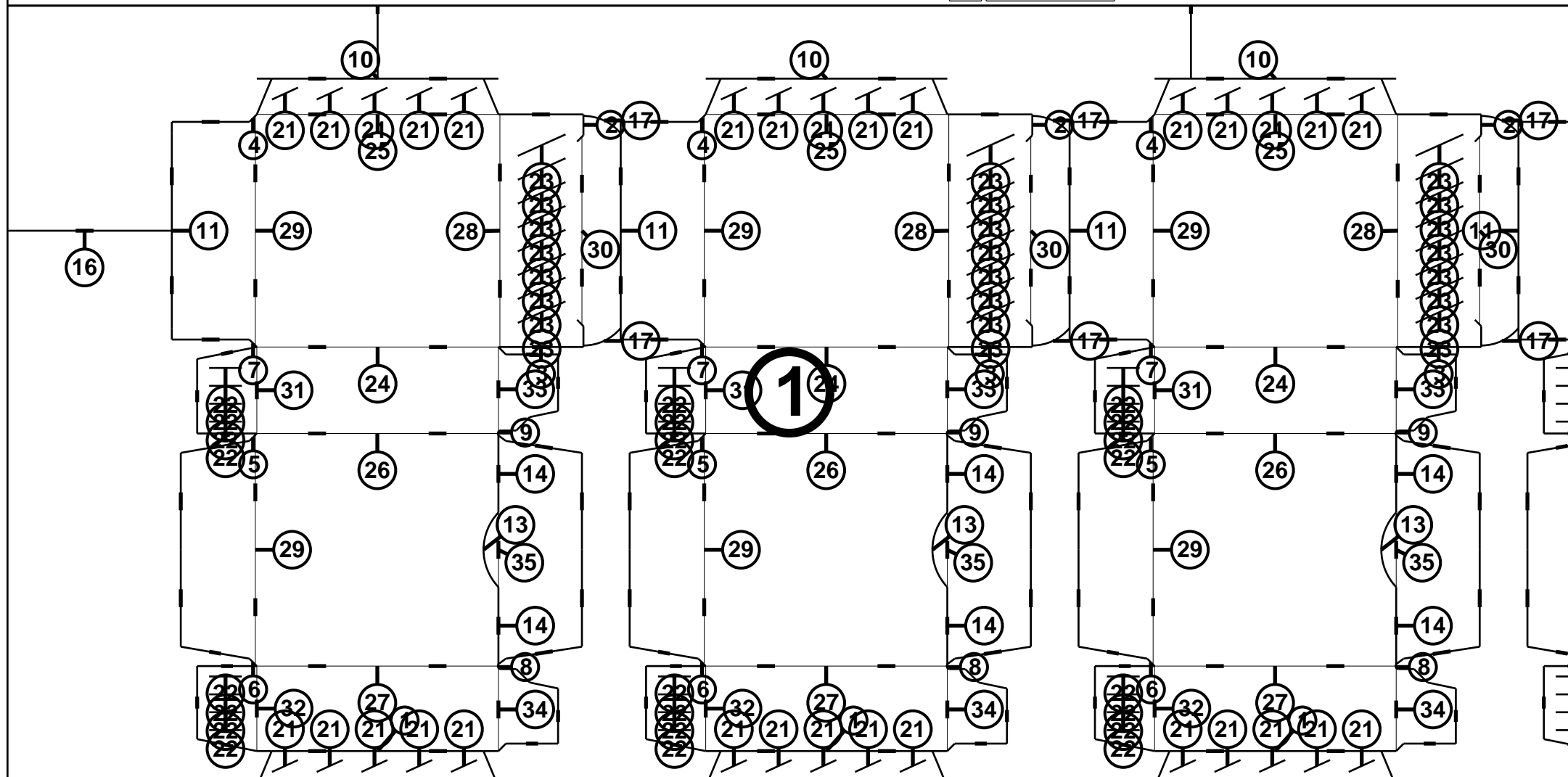

Line-No.	Date	27.02.2012	Order-No.		Amount		Supplier
	Path	aserpack/filesW	Author	Yashin A	Height		Laserpack Fryazino
	File	d> ECMA_A41...dds	Customer		Manufacturer		
	Holz 10/15/18		Line type		Material		
	Sonstiges		Pointage		Mat. Table		

Rule Processing System ACS 100 for ISO 9000

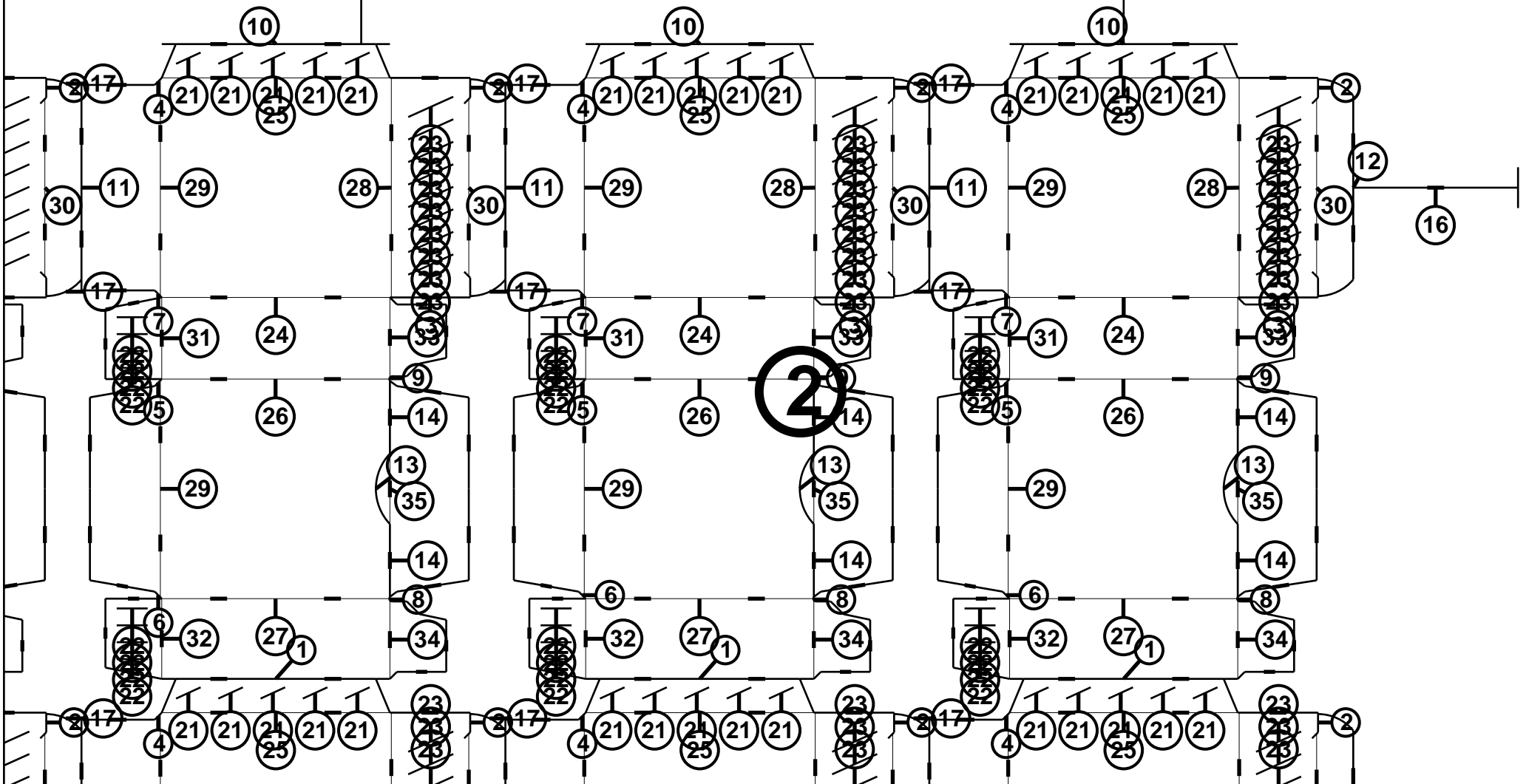

Line-No.	Date	27.02.2012	Order-No.		Amount		Supplier
	Path	aserpack/filesW	Author	Yashin A	Height		Laserpack Fryazino
	File	d> ECMA_A41...dds	Customer		Manufacturer		
	Holz 10/15/18		Line type		Material		
	Sonstiges		Pointage		Mat. Table		
						Die-Side	

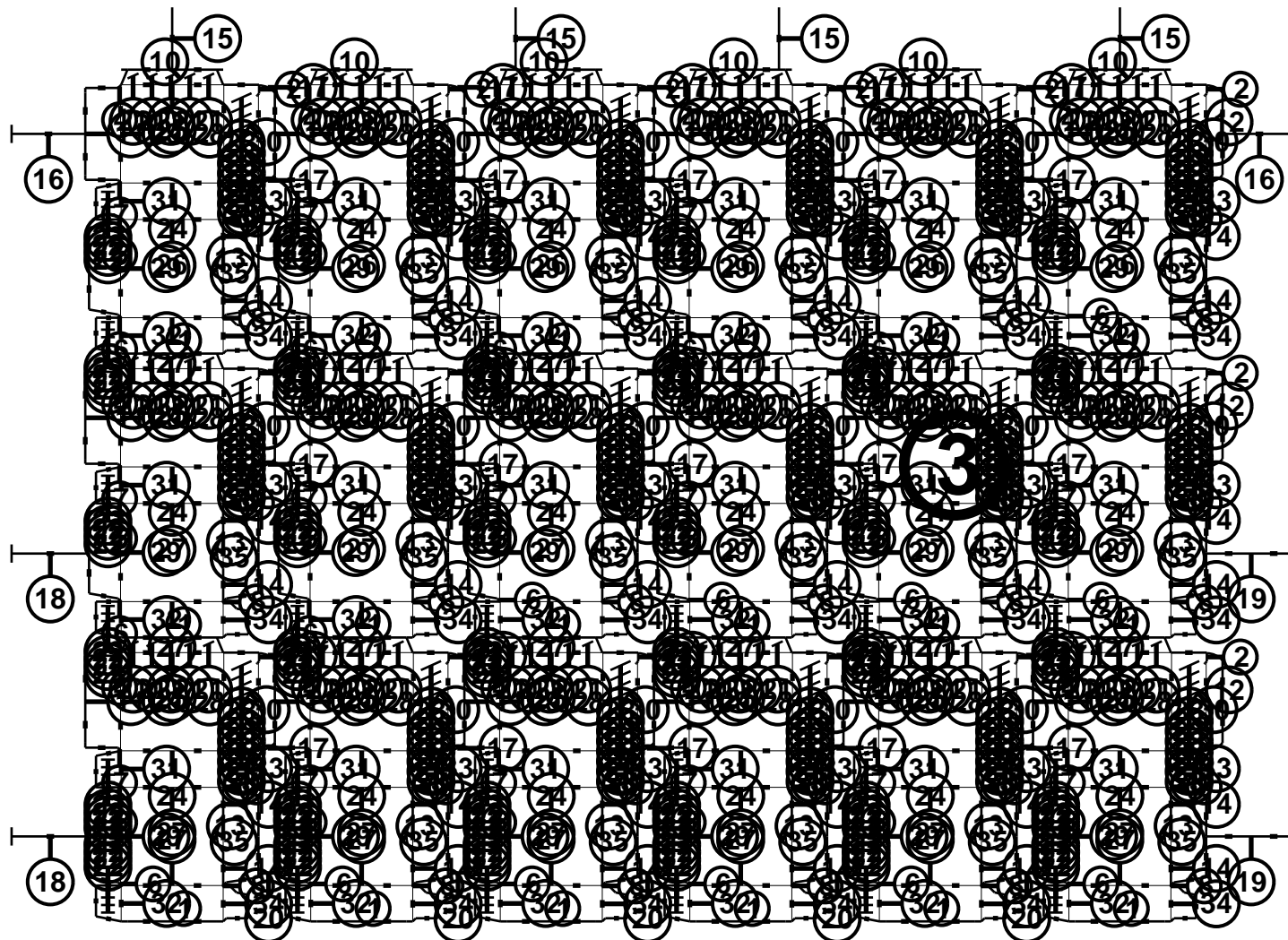

Line-No.	Date	27.02.2012	Order-No.		Amount		Supplier
	Path	aserpack/filesW	Author	Yashin A	Height		Laserpack Fryazino
	File	d> ECMA_A41...dds	Customer		Manufacturer		
	Holz 10/15/18		Line type		Material		
	Sonstiges		Pointage		Mat. Table		

Rule Processing System ACS 100 for ISO 9000

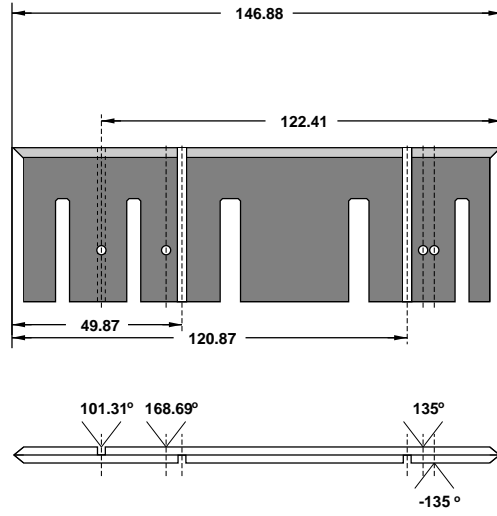
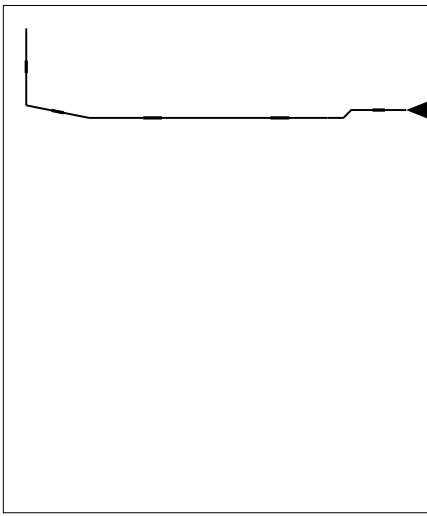

1	Line-No.	Date	27.02.2012	Order-No.		Amount	18	Supplier	
	Path	asercpack/filesW	Author	Yashin A	Height	23.80		Laserpack Fryazino	
	File	d> ECMA_A41...dds	Customer		Manufacturer	Boehler			
	Holz 10/15/18		Line type	Cut	Material	UNIVERSAL-T30			
	Sonstiges		Pointage	2.00	Mat. Table	04	Die-Side		

Rule Processing System ACS 100 for ISO 9000

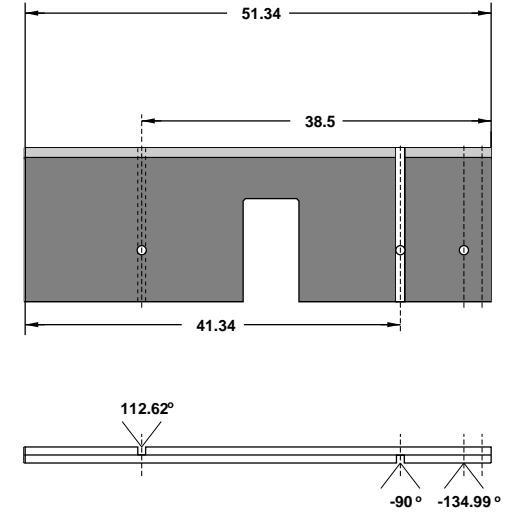
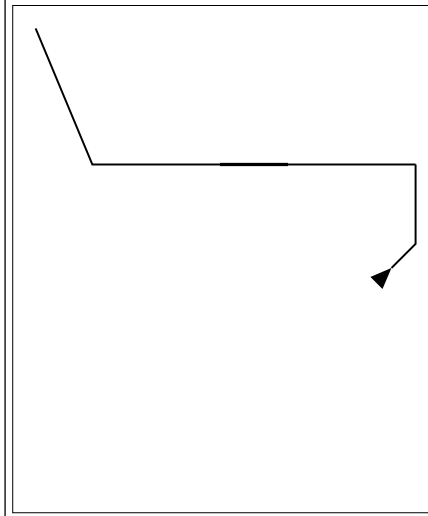

2	Line-No.	Date	27.02.2012	Order-No.		Amount	18	Supplier	
	Path	asercpack/filesW	Author	Yashin A	Height	23.80		Laserpack Fryazino	
	File	d> ECMA_A41...dds	Customer		Manufacturer	Boehler			
	Holz 10/15/18		Line type	PERFO	Material	UNIVERSAL-T30			
	Sonstiges		Pointage	2.00	Mat. Table	04	Die-Side		

Rule Processing System ACS 100 for ISO 9000

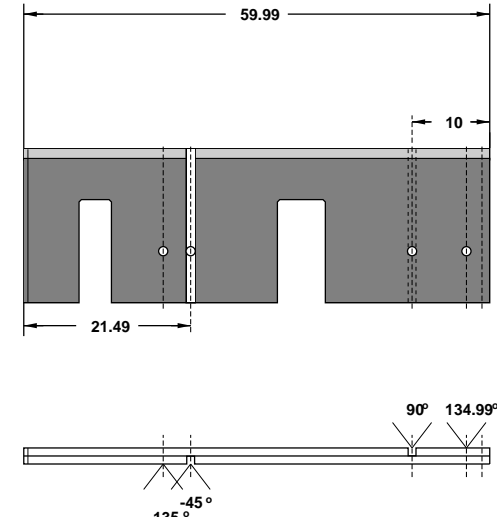
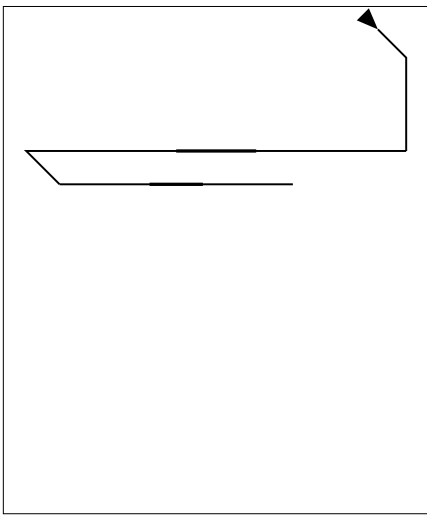

3	Line-No.	Date	27.02.2012	Order-No.		Amount	18	Supplier	
	Path	asercpack/filesW	Author	Yashin A	Height	23.80		Laserpack Fryazino	
	File	d> ECMA_A41...dds	Customer		Manufacturer	Boehler			
	Holz 10/15/18		Line type	PERFO	Material	UNIVERSAL-T30			
	Sonstiges		Pointage	2.00	Mat. Table	04	Die-Side		

Rule Processing System ACS 100 for ISO 9000

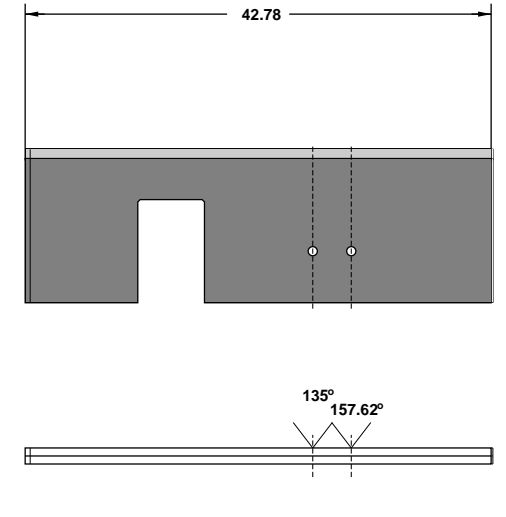
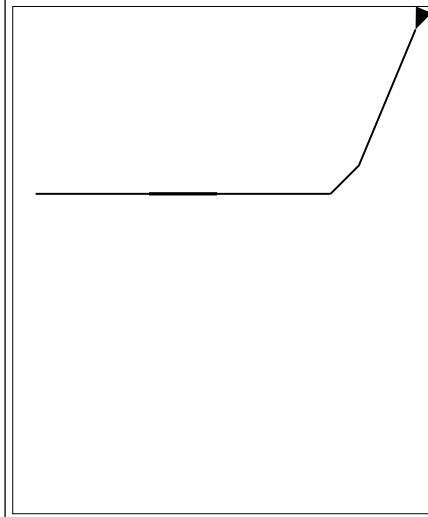

4	Line-No.	Date	27.02.2012	Order-No.		Amount	18	Supplier	
	Path	asercpack/filesW	Author	Yashin A	Height	23.80		Laserpack Fryazino	
	File	d> ECMA_A41...dds	Customer		Manufacturer	Boehler			
	Holz 10/15/18		Line type	Cut	Material	UNIVERSAL-T30			
	Sonstiges		Pointage	2.00	Mat. Table	04	Die-Side		

Rule Processing System ACS 100 for ISO 9000

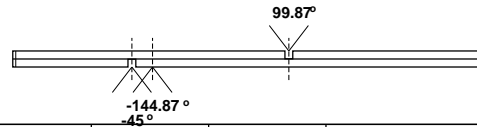
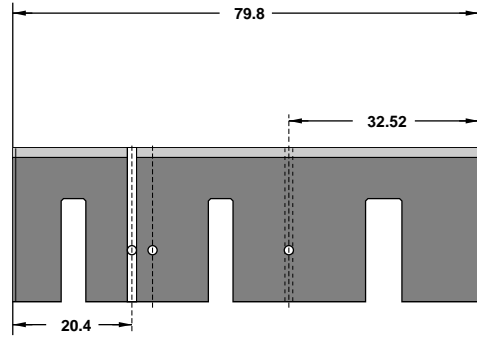
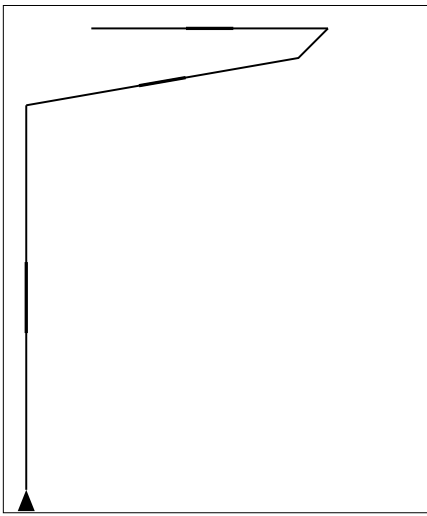

5	Line-No.	Date	27.02.2012	Order-No.		Amount	18	Supplier	
	Path	asercpack/filesW	Author	Yashin A	Height	23.80		Laserpack Fryazino	
	File	d> ECMA_A41...dds	Customer		Manufacturer	Boehler			
	Holz 10/15/18		Line type	Cut	Material	UNIVERSAL-T30			
	Sonstiges		Pointage	2.00	Mat. Table	04	Die-Side		

Rule Processing System ACS 100 for ISO 9000

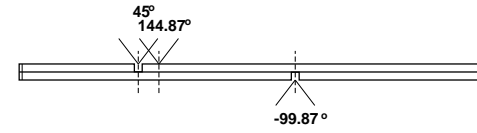
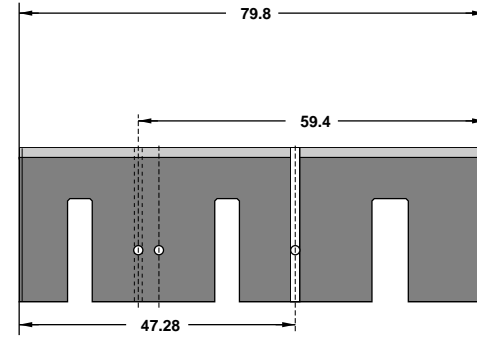
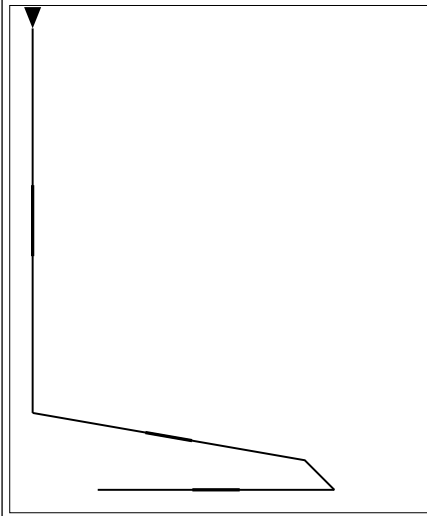

6	Line-No.	Date	27.02.2012	Order-No.		Amount	18	Supplier	
	Path	asercpack/filesW	Author	Yashin A	Height	23.80		Laserpack Fryazino	
	File	d> ECMA_A41...dds	Customer		Manufacturer	Boehler			
	Holz 10/15/18		Line type	Cut	Material	UNIVERSAL-T30			
	Sonstiges		Pointage	2.00	Mat. Table	04	Die-Side		

Rule Processing System ACS 100 for ISO 9000

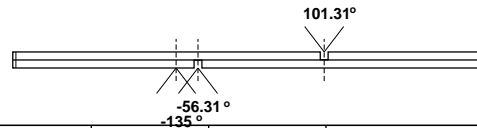
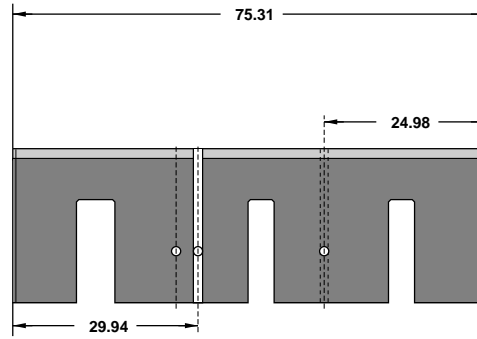
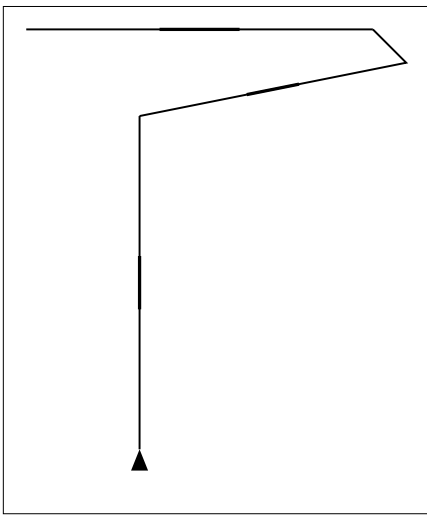

7	Line-No.	Date	27.02.2012	Order-No.		Amount	18	Supplier	
	Path	asercpack/filesW	Author	Yashin A	Height	23.80		Laserpack Fryazino	
	File	d> ECMA_A41...dds	Customer		Manufacturer	Boehler			
	Holz 10/15/18		Line type	Cut	Material	UNIVERSAL-T30			
	Sonstiges		Pointage	2.00	Mat. Table	04	Die-Side		

Rule Processing System ACS 100 for ISO 9000

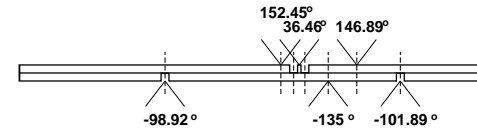
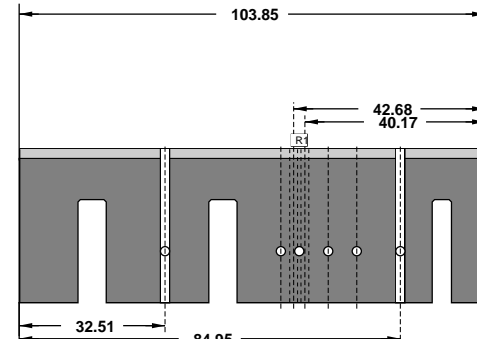
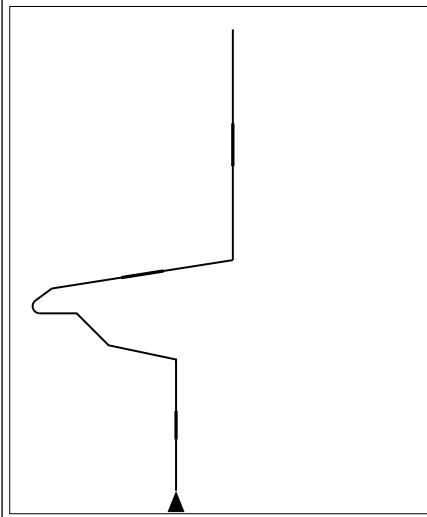

8	Line-No.	Date	27.02.2012	Order-No.		Amount	18	Supplier	
	Path	asercpack/filesW	Author	Yashin A	Height	23.80		Laserpack Fryazino	
	File	d> ECMA_A41...dds	Customer		Manufacturer	Boehler			
	Holz 10/15/18		Line type	Cut	Material	UNIVERSAL-T30			
	Sonstiges		Pointage	2.00	Mat. Table	04	Die-Side		

Rule Processing System ACS 100 for ISO 9000

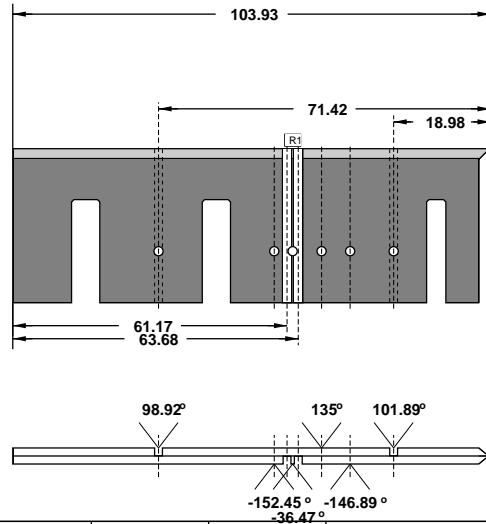
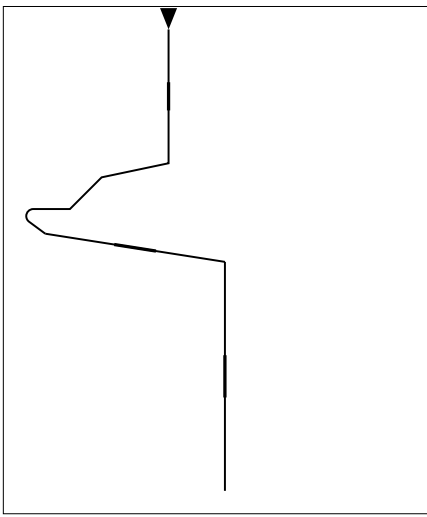

9	Line-No.	Date	27.02.2012	Order-No.		Amount	18	Supplier
	Path	asercpack/filesW	Author	Yashin A	Height	23.80	Laserpack Fryazino	
	File	d> ECMA_A41...dds	Customer		Manufacturer	Boehler		
	Holz 10/15/18		Line type	Cut	Material	UNIVERSAL-T30		
	Sonstiges		Pointage	2.00	Mat. Table	04	Die-Side	

Rule Processing System ACS 100 for ISO 9000

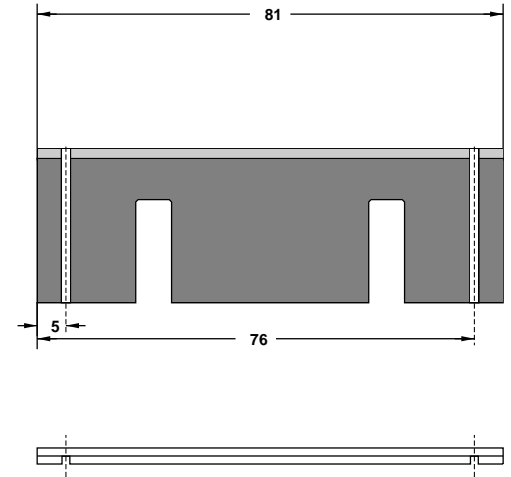
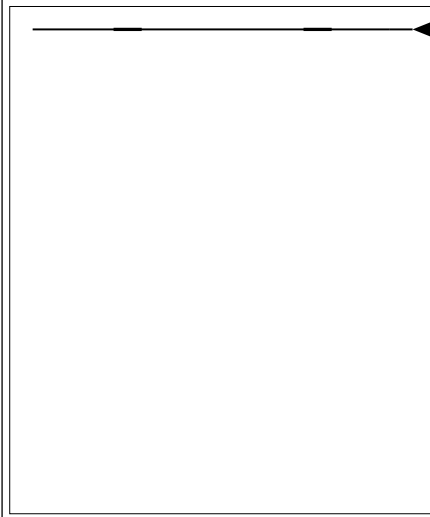

10	Line-No.	Date	27.02.2012	Order-No.		Amount	6	Supplier
	Path	asercpack/filesW	Author	Yashin A	Height	23.80	Laserpack Fryazino	
	File	d> ECMA_A41...dds	Customer		Manufacturer	Boehler		
	Holz 10/15/18		Line type	Cut	Material	UNIVERSAL-T30		
	Sonstiges		Pointage	2.00	Mat. Table	04	Die-Side	

Rule Processing System ACS 100 for ISO 9000

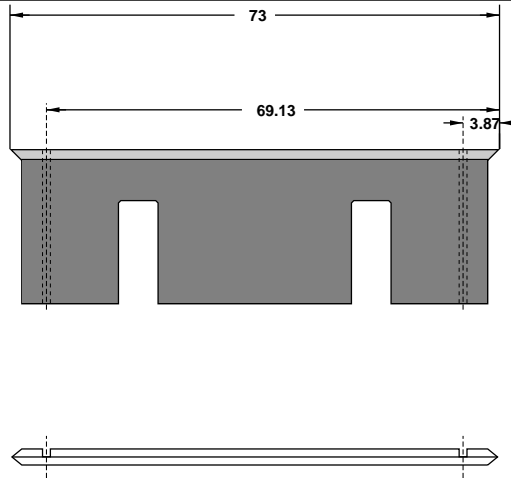
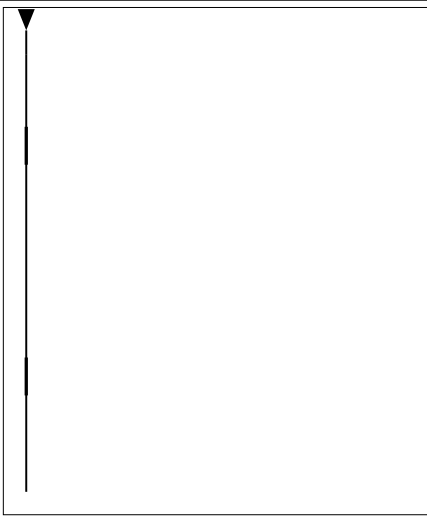

11	Line-No.	Date	27.02.2012	Order-No.		Amount	18	Supplier
	Path	asercpack/filesW	Author	Yashin A	Height	23.80	Laserpack Fryazino	
	File	d> ECMA_A41...dds	Customer		Manufacturer	Boehler		
	Holz 10/15/18		Line type	Cut	Material	UNIVERSAL-T30		
	Sonstiges		Pointage	2.00	Mat. Table	04	Die-Side	

Rule Processing System ACS 100 for ISO 9000

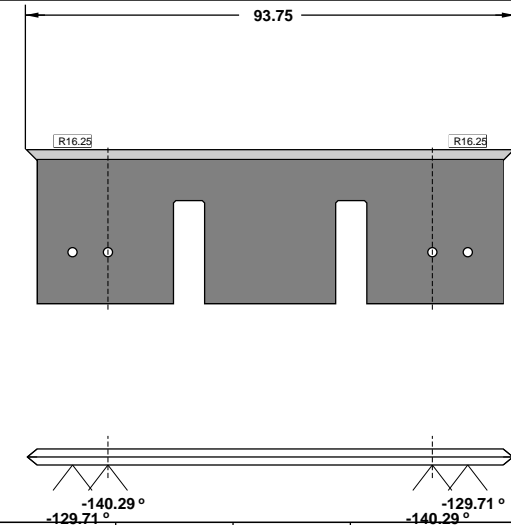
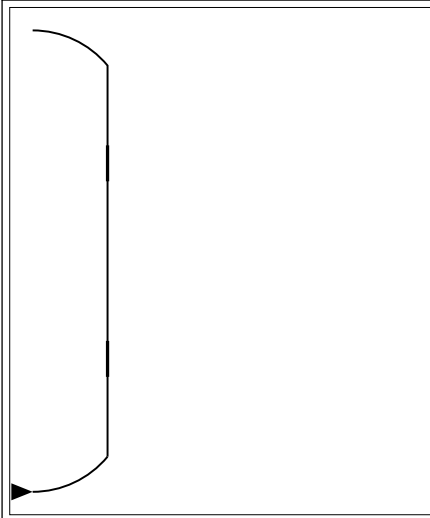

12	Line-No.	Date	27.02.2012	Order-No.		Amount	3	Supplier
	Path	asercpack/filesW	Author	Yashin A	Height	23.80	Laserpack Fryazino	
	File	d> ECMA_A41...dds	Customer		Manufacturer	Boehler		
	Holz 10/15/18		Line type	Cut	Material	UNIVERSAL-T30		
	Sonstiges		Pointage	2.00	Mat. Table	04	Die-Side	

Rule Processing System ACS 100 for ISO 9000

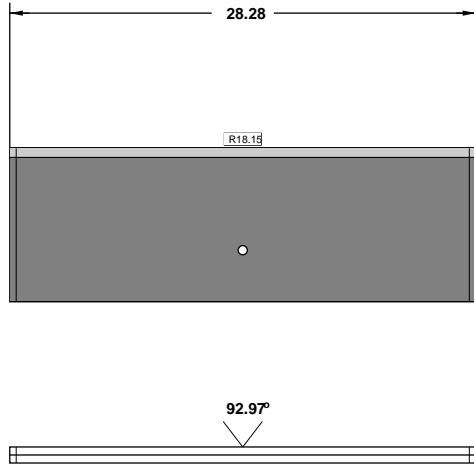
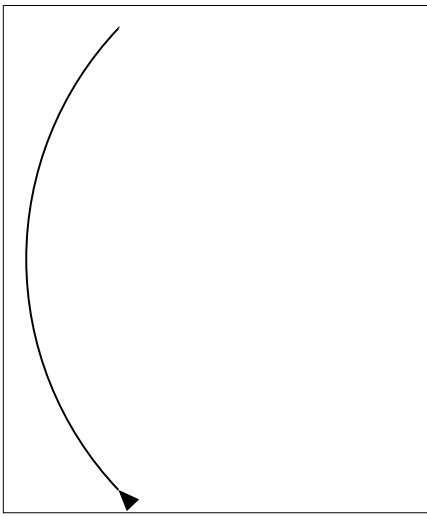

13	Line-No.	Date	27.02.2012	Order-No.		Amount	18	Supplier	
	Path	aserpack/filesW	Author	Yashin A	Height	23.80	Laserpack Fryazino		
	File	d> ECMA_A41...dds	Customer		Manufacturer	Boehler			
	Holz 10/15/18		Line type	PERFO	Material	UNIVERSAL-T30			
	Sonstiges		Pointage	2.00	Mat. Table	04	Die-Side		

Rule Processing System ACS 100 for ISO 9000

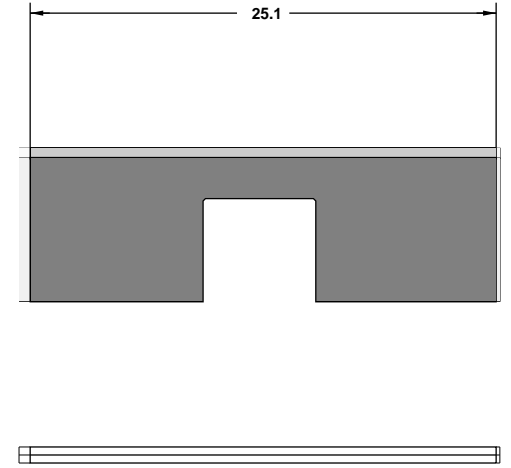

14	Line-No.	Date	27.02.2012	Order-No.		Amount	36	Supplier	
	Path	aserpack/filesW	Author	Yashin A	Height	23.80	Laserpack Fryazino		
	File	d> ECMA_A41...dds	Customer		Manufacturer	Boehler			
	Holz 10/15/18		Line type	PERFO	Material	UNIVERSAL-T30			
	Sonstiges		Pointage	2.00	Mat. Table	04	Die-Side		

Rule Processing System ACS 100 for ISO 9000

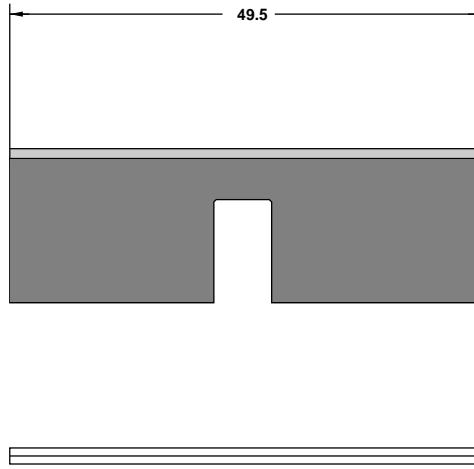
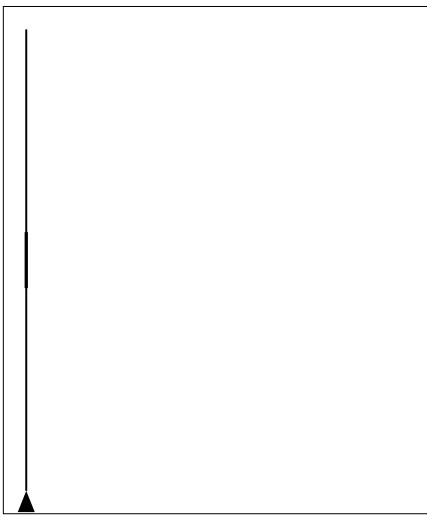

15	Line-No.	Date	27.02.2012	Order-No.		Amount	4	Supplier	
	Path	aserpack/filesW	Author	Yashin A	Height	23.80	Laserpack Fryazino		
	File	d> ECMA_A41...dds	Customer		Manufacturer	Boehler			
	Holz 10/15/18		Line type	Cut	Material	UNIVERSAL-T30			
	Sonstiges		Pointage	2.00	Mat. Table	04	Die-Side		

Rule Processing System ACS 100 for ISO 9000

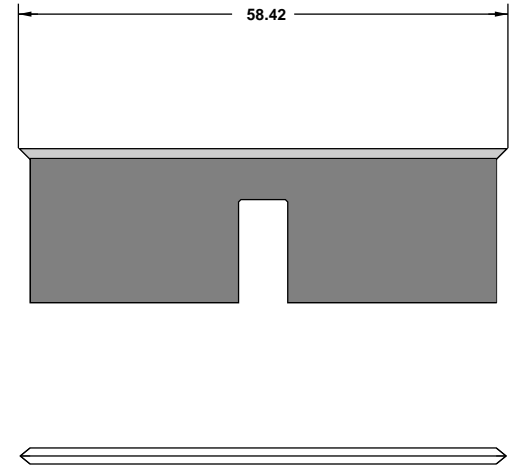
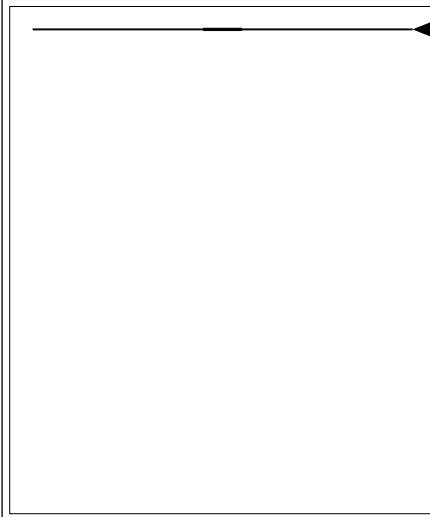

16	Line-No.	Date	27.02.2012	Order-No.		Amount	2	Supplier	
	Path	aserpack/filesW	Author	Yashin A	Height	23.80	Laserpack Fryazino		
	File	d> ECMA_A41...dds	Customer		Manufacturer	Boehler			
	Holz 10/15/18		Line type	Cut	Material	UNIVERSAL-T30			
	Sonstiges		Pointage	2.00	Mat. Table	04	Die-Side		

Rule Processing System ACS 100 for ISO 9000

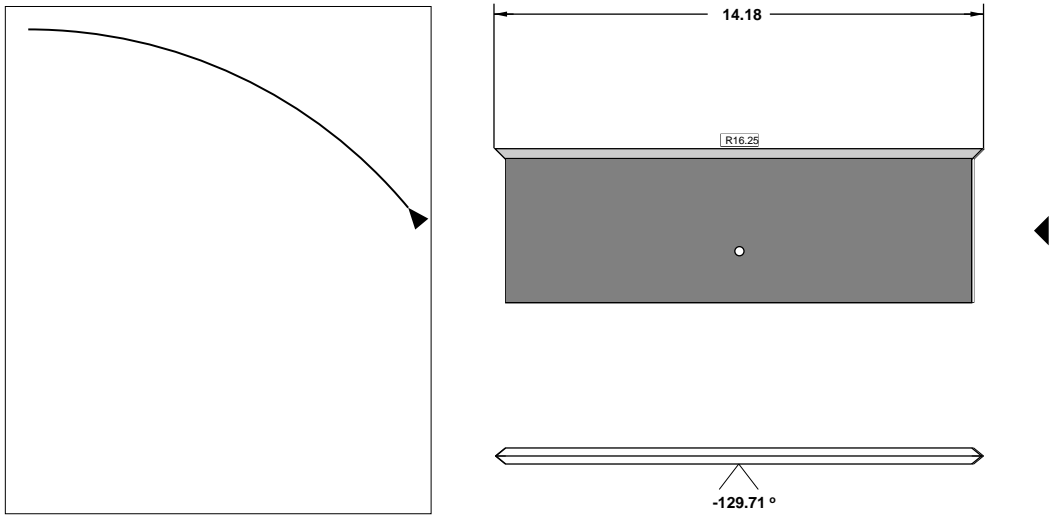

17	Line-No.	Date	27.02.2012	Order-No.		Amount	30	Supplier
	Path	aserpack/filesW	Author	Yashin A	Height	23.80	Laserpack Fryazino	
	File	d> ECMA_A41...dds	Customer		Manufacturer	Boehler		
	Holz 10/15/18		Line type	Cut	Material	UNIVERSAL-T30	Die-Side	
	Sonstiges		Pointage	2.00	Mat. Table	04		

Rule Processing System ACS 100 for ISO 9000

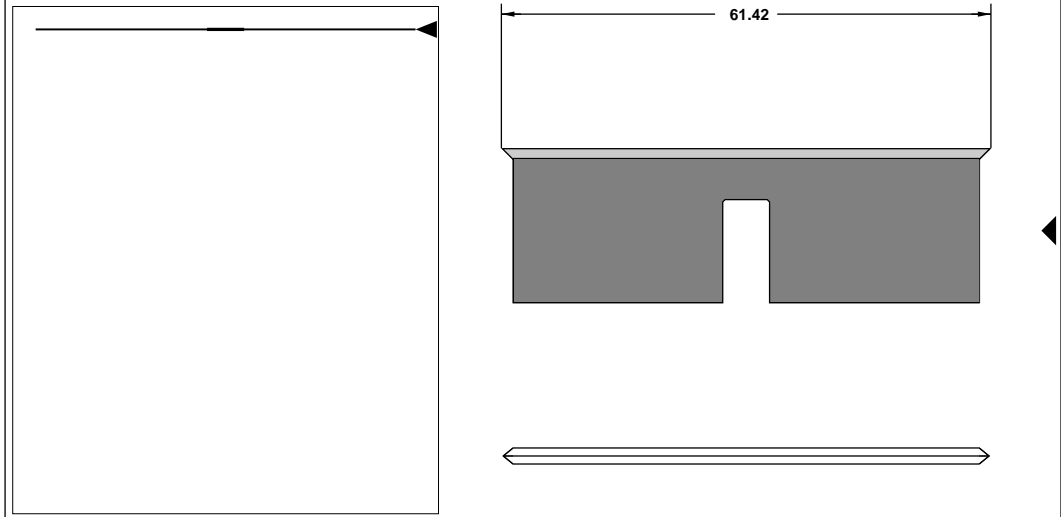

18	Line-No.	Date	27.02.2012	Order-No.		Amount	2	Supplier
	Path	aserpack/filesW	Author	Yashin A	Height	23.80	Laserpack Fryazino	
	File	d> ECMA_A41...dds	Customer		Manufacturer	Boehler		
	Holz 10/15/18		Line type	Cut	Material	UNIVERSAL-T30	Die-Side	
	Sonstiges		Pointage	2.00	Mat. Table	04		

Rule Processing System ACS 100 for ISO 9000

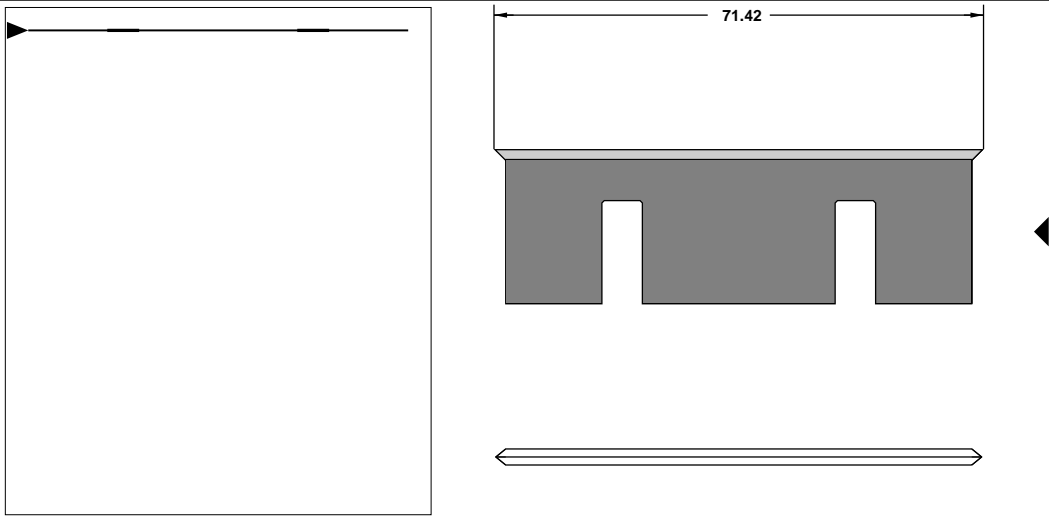

19	Line-No.	Date	27.02.2012	Order-No.		Amount	2	Supplier
	Path	aserpack/filesW	Author	Yashin A	Height	23.80	Laserpack Fryazino	
	File	d> ECMA_A41...dds	Customer		Manufacturer	Boehler		
	Holz 10/15/18		Line type	Cut	Material	UNIVERSAL-T30	Die-Side	
	Sonstiges		Pointage	2.00	Mat. Table	04		

Rule Processing System ACS 100 for ISO 9000

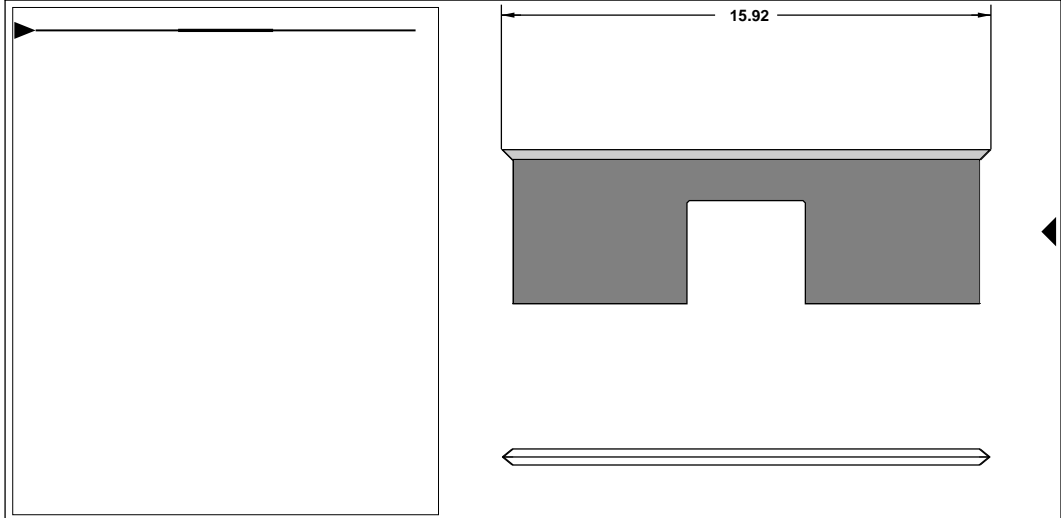

20	Line-No.	Date	27.02.2012	Order-No.		Amount	5	Supplier
	Path	aserpack/filesW	Author	Yashin A	Height	23.80	Laserpack Fryazino	
	File	d> ECMA_A41...dds	Customer		Manufacturer	Boehler		
	Holz 10/15/18		Line type	Cut	Material	UNIVERSAL-T30	Die-Side	
	Sonstiges		Pointage	2.00	Mat. Table	04		

Rule Processing System ACS 100 for ISO 9000

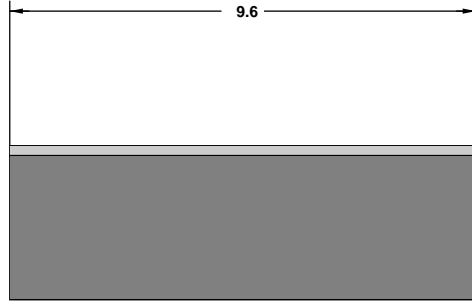
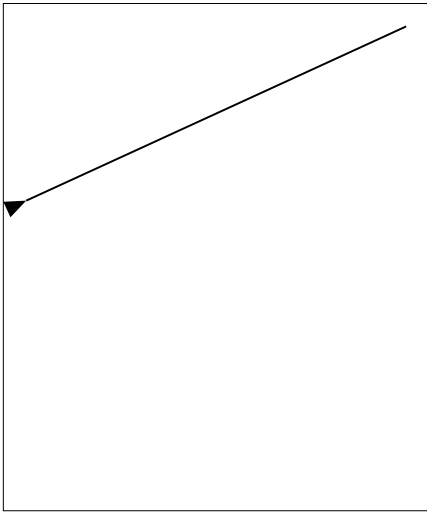

PERFO KLEEVAY



Line-No.	Date	27.02.2012	Order-No.		Amount	90	Supplier	
21	Path	aserpack/filesW	Author	Yashin A	Height	23.80	Laserpack Fryazino	
	File	d> ECMA_A41...dds	Customer		Manufacturer	Boehler		
	Holz 10/15/18		Line type	PERFO	Material	UNIVERSAL-T30		
	Sonstiges		Pointage	2.00	Mat. Table	04		Die-Side

Rule Processing System ACS 100 for ISO 9000

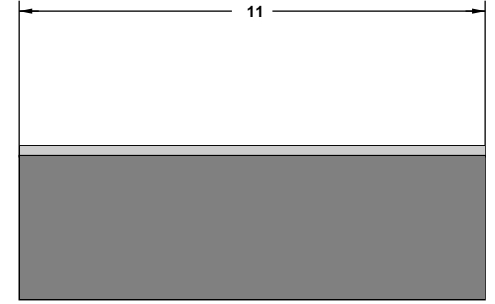
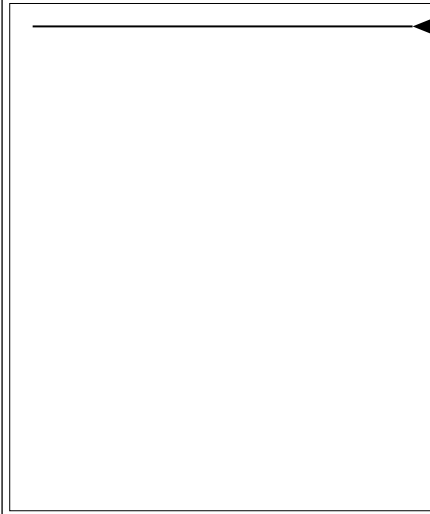

PERFO KLEEVAY



Line-No.	Date	27.02.2012	Order-No.		Amount	144	Supplier	
22	Path	aserpack/filesW	Author	Yashin A	Height	23.80	Laserpack Fryazino	
	File	d> ECMA_A41...dds	Customer		Manufacturer	Boehler		
	Holz 10/15/18		Line type	PERFO	Material	UNIVERSAL-T30		
	Sonstiges		Pointage	2.00	Mat. Table	04		Die-Side

Rule Processing System ACS 100 for ISO 9000

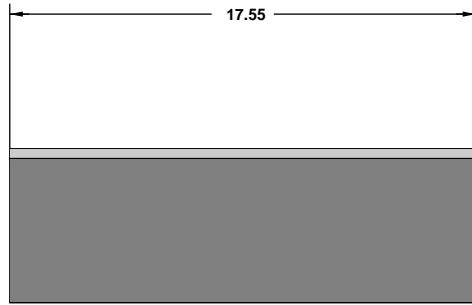
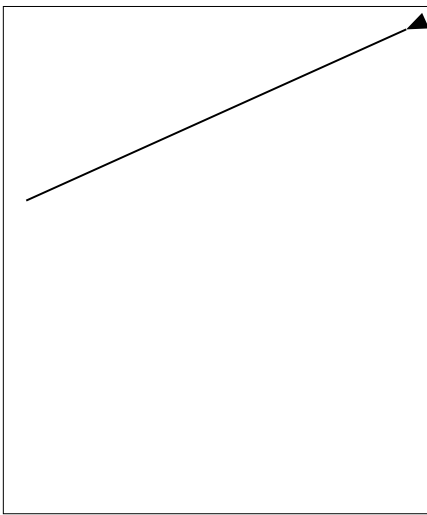

PERFO KLEEVAY



Line-No.	Date	27.02.2012	Order-No.		Amount	144	Supplier	
23	Path	aserpack/filesW	Author	Yashin A	Height	23.80	Laserpack Fryazino	
	File	d> ECMA_A41...dds	Customer		Manufacturer	Boehler		
	Holz 10/15/18		Line type	PERFO	Material	UNIVERSAL-T30		
	Sonstiges		Pointage	2.00	Mat. Table	04		Die-Side

Rule Processing System ACS 100 for ISO 9000

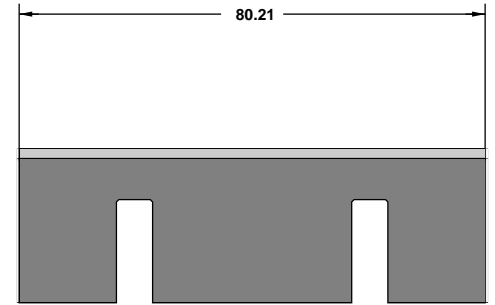
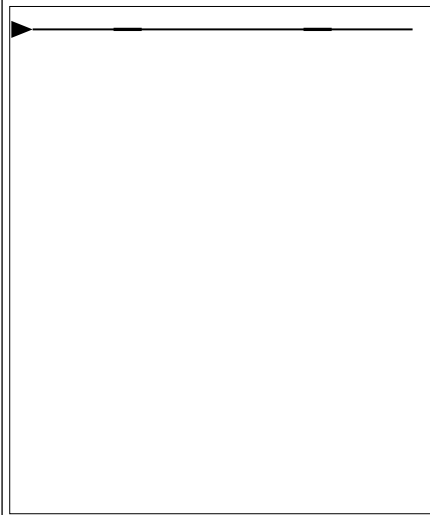

Line-No.	Date	27.02.2012	Order-No.		Amount	18	Supplier	
24	Path	aserpack/filesW	Author	Yashin A	Height	23.20	Laserpack Fryazino	
	File	d> ECMA_A41...dds	Customer		Manufacturer	Boehler		
	Holz 10/15/18		Line type	Crease	Material	UNIVERSAL-T30		
	Sonstiges		Pointage	2.00	Mat. Table	04		Die-Side

Rule Processing System ACS 100 for ISO 9000

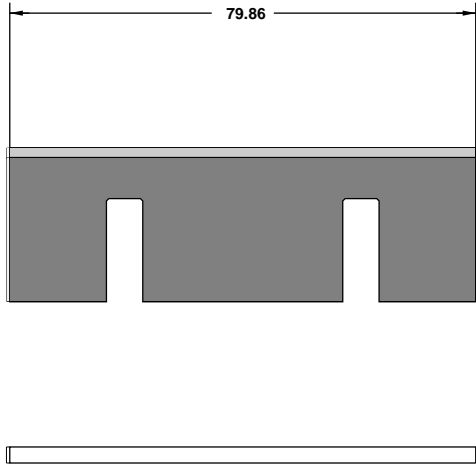
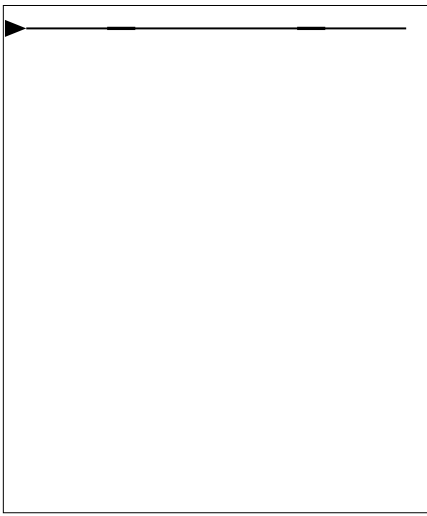

25	Line-No.		Date	27.02.2012	Order-No.		Amount	18	Supplier	
	Path	aserpack/filesW	Author	Yashin A	Height	23.20	Laserpack Fryazino			
	File	d> ECMA_A41...dds	Customer		Manufacturer	Boehler				
	Holz 10/15/18		Line type	Crease	Material	UNIVERSAL-T30				
	Sonstiges		Pointage	2.00	Mat. Table	04	Die-Side			

Rule Processing System ACS 100 for ISO 9000

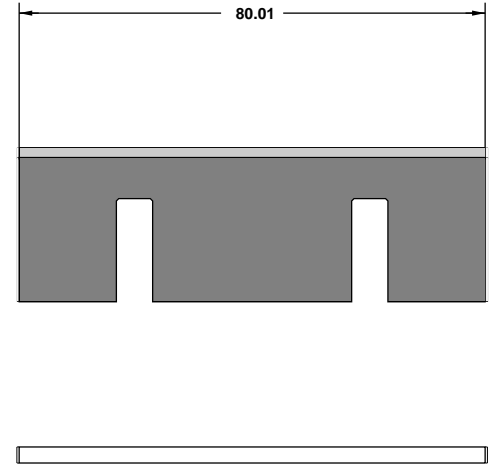
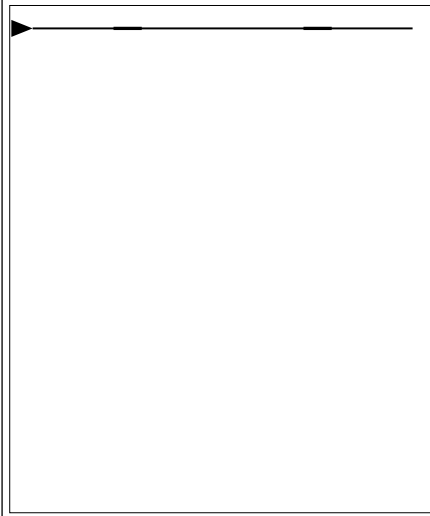

26	Line-No.		Date	27.02.2012	Order-No.		Amount	6	Supplier	
	Path	aserpack/filesW	Author	Yashin A	Height	23.20	Laserpack Fryazino			
	File	d> ECMA_A41...dds	Customer		Manufacturer	Boehler				
	Holz 10/15/18		Line type	Crease	Material	UNIVERSAL-T30				
	Sonstiges		Pointage	2.00	Mat. Table	04	Die-Side			

Rule Processing System ACS 100 for ISO 9000

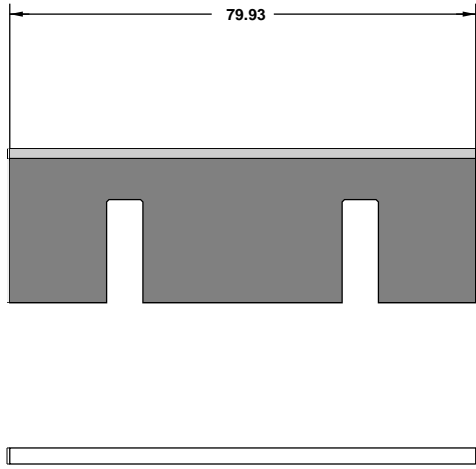
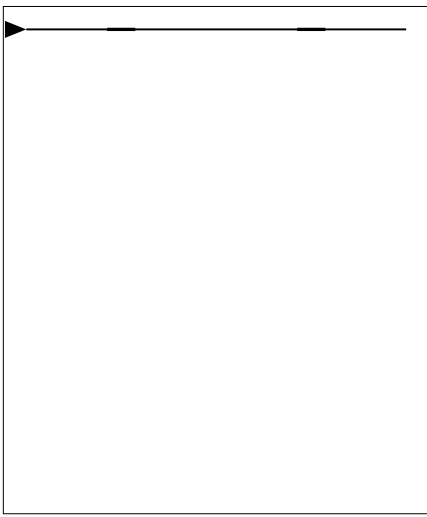

27	Line-No.		Date	27.02.2012	Order-No.		Amount	30	Supplier	
	Path	aserpack/filesW	Author	Yashin A	Height	23.20	Laserpack Fryazino			
	File	d> ECMA_A41...dds	Customer		Manufacturer	Boehler				
	Holz 10/15/18		Line type	Crease	Material	UNIVERSAL-T30				
	Sonstiges		Pointage	2.00	Mat. Table	04	Die-Side			

Rule Processing System ACS 100 for ISO 9000

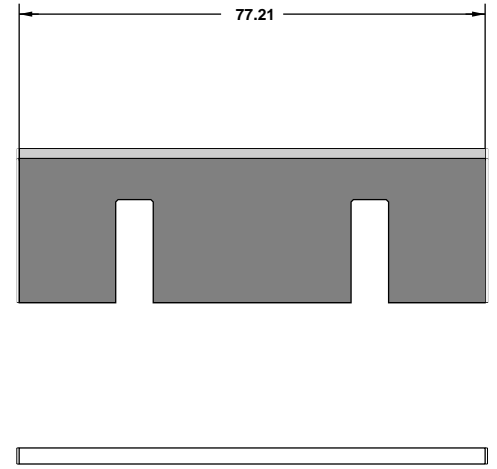

28	Line-No.		Date	27.02.2012	Order-No.		Amount	18	Supplier	
	Path	aserpack/filesW	Author	Yashin A	Height	23.20	Laserpack Fryazino			
	File	d> ECMA_A41...dds	Customer		Manufacturer	Boehler				
	Holz 10/15/18		Line type	Crease	Material	UNIVERSAL-T30				
	Sonstiges		Pointage	2.00	Mat. Table	04	Die-Side			

Rule Processing System ACS 100 for ISO 9000

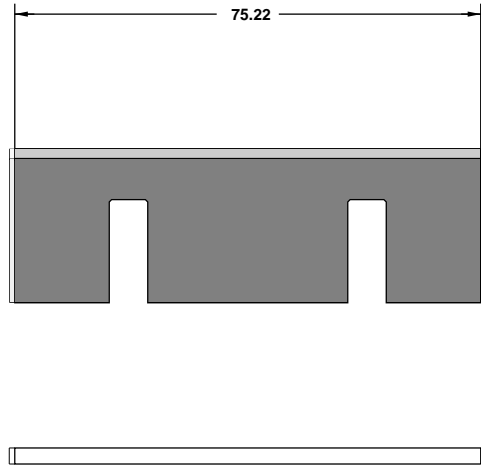
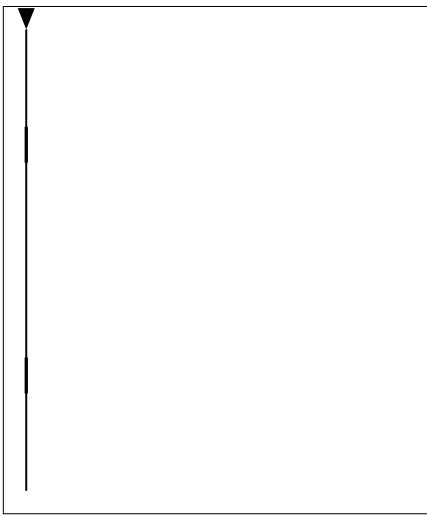

29	Line-No.		Date	27.02.2012	Order-No.		Amount	36	Supplier	
	Path	aserpack/filesW	Author	Yashin A	Height	23.20	Laserpack Fryazino			
	File	d> ECMA_A41...dds	Customer		Manufacturer	Boehler				
	Holz 10/15/18		Line type	Crease	Material	UNIVERSAL-T30				
	Sonstiges		Pointage	2.00	Mat. Table	04	Die-Side			

Rule Processing System ACS 100 for ISO 9000

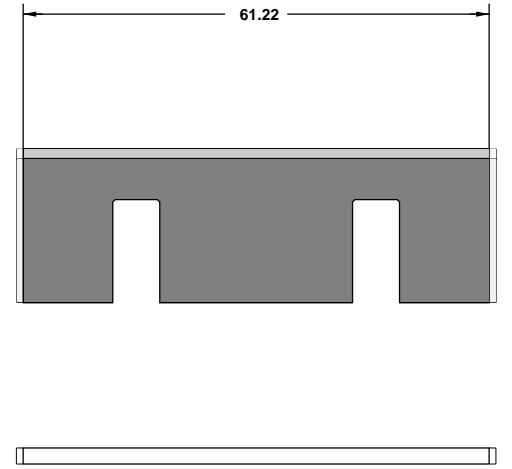

30	Line-No.		Date	27.02.2012	Order-No.		Amount	18	Supplier	
	Path	aserpack/filesW	Author	Yashin A	Height	23.20	Laserpack Fryazino			
	File	d> ECMA_A41...dds	Customer		Manufacturer	Boehler				
	Holz 10/15/18		Line type	Crease	Material	UNIVERSAL-T30				
	Sonstiges		Pointage	2.00	Mat. Table	04	Die-Side			

Rule Processing System ACS 100 for ISO 9000

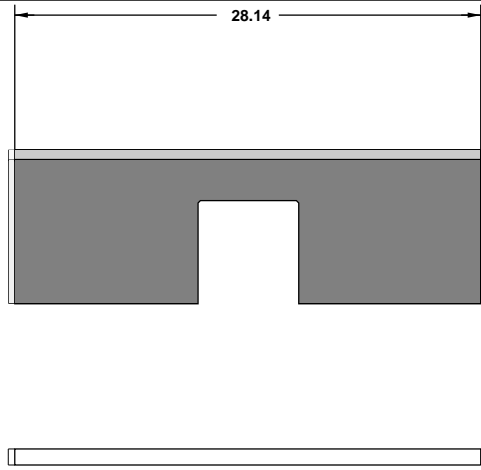
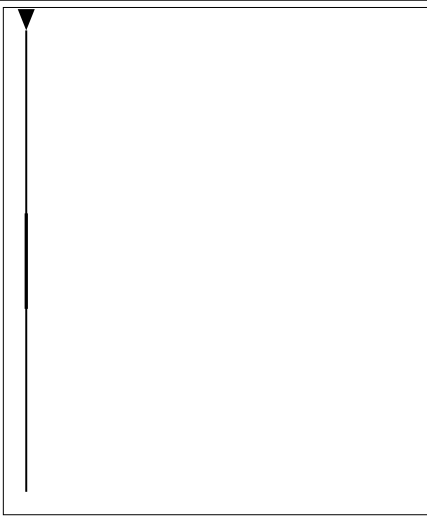

31	Line-No.		Date	27.02.2012	Order-No.		Amount	18	Supplier	
	Path	aserpack/filesW	Author	Yashin A	Height	23.20	Laserpack Fryazino			
	File	d> ECMA_A41...dds	Customer		Manufacturer	Boehler				
	Holz 10/15/18		Line type	Crease	Material	UNIVERSAL-T30				
	Sonstiges		Pointage	2.00	Mat. Table	04	Die-Side			

Rule Processing System ACS 100 for ISO 9000

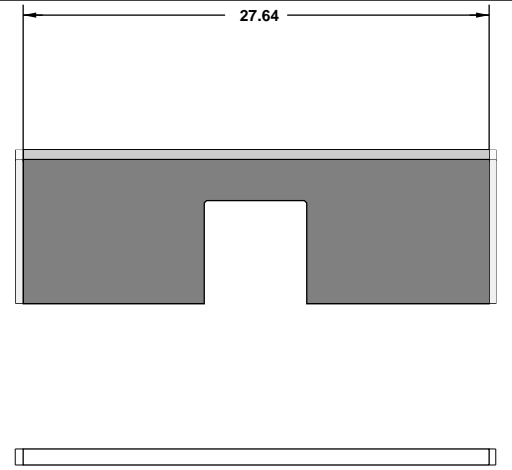

32	Line-No.		Date	27.02.2012	Order-No.		Amount	18	Supplier	
	Path	aserpack/filesW	Author	Yashin A	Height	23.20	Laserpack Fryazino			
	File	d> ECMA_A41...dds	Customer		Manufacturer	Boehler				
	Holz 10/15/18		Line type	Crease	Material	UNIVERSAL-T30				
	Sonstiges		Pointage	2.00	Mat. Table	04	Die-Side			

Rule Processing System ACS 100 for ISO 9000

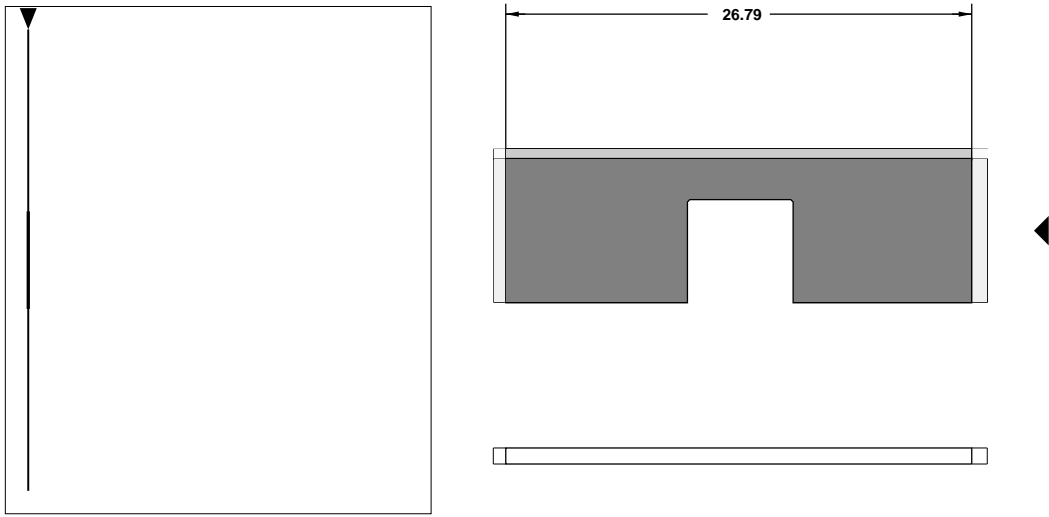

Line-No.	Date	27.02.2012	Order-No.		Amount	18	Supplier
33	Path	aserpack/filesW	Author	Yashin A	Height	23.20	Laserpack Fryazino
	File	d> ECMA_A41...dds	Customer		Manufacturer	Boehler	
	Holz 10/15/18		Line type	Crease	Material	UNIVERSAL-T30	
	Sonstiges		Pointage	2.00	Mat. Table	04	
			Die-Side				

Rule Processing System ACS 100 for ISO 9000

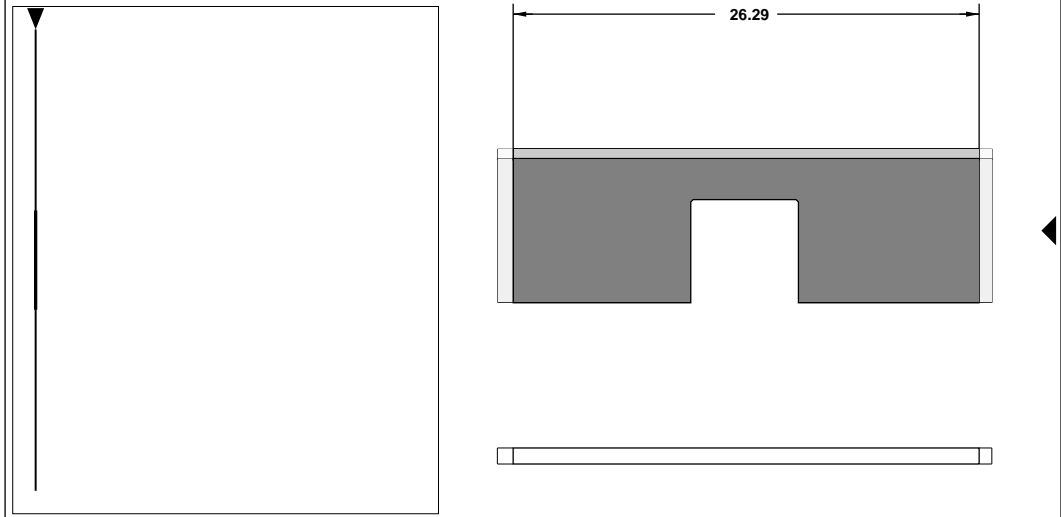

Line-No.	Date	27.02.2012	Order-No.		Amount	18	Supplier
34	Path	aserpack/filesW	Author	Yashin A	Height	23.20	Laserpack Fryazino
	File	d> ECMA_A41...dds	Customer		Manufacturer	Boehler	
	Holz 10/15/18		Line type	Crease	Material	UNIVERSAL-T30	
	Sonstiges		Pointage	2.00	Mat. Table	04	
			Die-Side				

Rule Processing System ACS 100 for ISO 9000

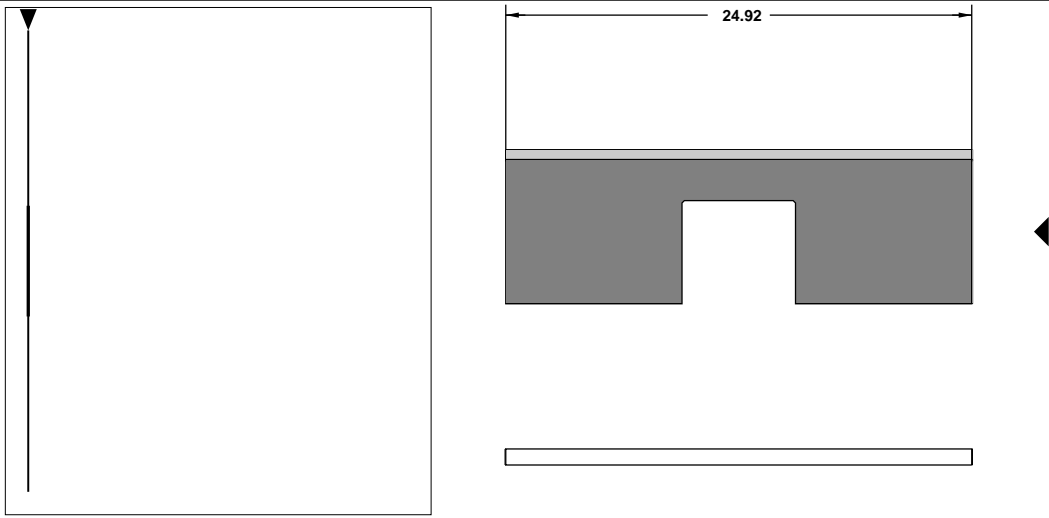

Line-No.	Date	27.02.2012	Order-No.		Amount	18	Supplier
35	Path	aserpack/filesW	Author	Yashin A	Height	23.80	Laserpack Fryazino
	File	d> ECMA_A41...dds	Customer		Manufacturer	Boehler	
	Holz 10/15/18		Line type	Crease	Material	UNIVERSAL-T30	
	Sonstiges		Pointage	2.00	Mat. Table	04	
			Die-Side				

Rule Processing System ACS 100 for ISO 9000



complete list

Date	File	Order-No.	Author	Customer	Up
27.02.2012	d> ECMA_A41...dds		Yashin A		1

No.	Line type	Height	Point.	Amount	Bridges		BEMDMARK		KBends		Broaching		Length	Sum	Total	Manufacturer	Mat. Table
					Sing.	Sum	Sing.	Sum	Sing.	Sum	Sing.	Sum					
1	Cut	23.80	2.00	18	5	90	4	72	4	72	3	54	146.88	2643.84	2643.84	Boehler	04
2	PERFO	23.80	2.00	18	1	18	3	54	3	54	2	36	51.34	924.12		Boehler	04
3	PERFO	23.80	2.00	18	2	36	4	72	4	72	2	36	59.99	1079.82	2003.94	Boehler	04
4	Cut	23.80	2.00	18	1	18	2	36	2	36	0	0	42.78	770.04		Boehler	04
5	Cut	23.80	2.00	18	3	54	3	54	3	54	2	36	79.80	1436.40		Boehler	04
6	Cut	23.80	2.00	18	3	54	3	54	3	54	2	36	79.80	1436.40		Boehler	04
7	Cut	23.80	2.00	18	3	54	3	54	3	54	2	36	75.31	1355.58		Boehler	04
8	Cut	23.80	2.00	18	3	54	6	108	5	90	4	72	103.85	1869.30		Boehler	04
9	Cut	23.80	2.00	18	3	54	6	108	5	90	4	72	103.93	1870.74		Boehler	04
10	Cut	23.80	2.00	6	2	12	0	0	0	0	2	12	81.00	486.00		Boehler	04
11	Cut	23.80	2.00	18	2	36	0	0	0	0	2	36	73.00	1314.00		Boehler	04
12	Cut	23.80	2.00	3	2	6	4	12	2	6	0	0	93.75	281.25	10819.71	Boehler	04
13	PERFO	23.80	2.00	18	0	0	1	18	0	0	0	0	28.28	509.04		Boehler	04
14	PERFO	23.80	2.00	36	1	36	0	0	0	0	0	0	25.10	903.60	1412.64	Boehler	04
15	Cut	23.80	2.00	4	1	4	0	0	0	0	0	0	49.50	198.00		Boehler	04
16	Cut	23.80	2.00	2	1	2	0	0	0	0	0	0	58.42	116.84		Boehler	04
17	Cut	23.80	2.00	30	0	0	1	30	0	0	0	0	14.18	425.40		Boehler	04
18	Cut	23.80	2.00	2	1	2	0	0	0	0	0	0	61.42	122.84		Boehler	04
19	Cut	23.80	2.00	2	2	4	0	0	0	0	0	0	71.42	142.84		Boehler	04
20	Cut	23.80	2.00	5	1	5	0	0	0	0	0	0	15.92	79.60	1085.52	Boehler	04

complete list

Date	File	Order-No.	Author	Customer	Up
27.02.2012	d> ECMA_A41...dds		Yashin A		1

No.	Line type	Height	Point.	Amount	Bridges		BEMDMAR		KBends		Broaching		Length	Sum	Total	Manufacturer	Mat. Table
					Sing.	Sum	Sing.	Sum	Sing.	Sum	Sing.	Sum					
21	PERFO	23.80	2.00	90	0	0	0	0	0	0	0	0	9.60	864.00		Boehler	04
22	PERFO	23.80	2.00	144	0	0	0	0	0	0	0	0	11.00	1584.00		Boehler	04
23	PERFO	23.80	2.00	144	0	0	0	0	0	0	0	0	17.55	2527.20	4975.20	Boehler	04
24	Crease	23.20	2.00	18	2	36	0	0	0	0	0	0	80.21	1443.78		Boehler	04
25	Crease	23.20	2.00	18	2	36	0	0	0	0	0	0	79.86	1437.48		Boehler	04
26	Crease	23.20	2.00	6	2	12	0	0	0	0	0	0	80.01	480.06		Boehler	04
27	Crease	23.20	2.00	30	2	60	0	0	0	0	0	0	79.93	2397.90		Boehler	04
28	Crease	23.20	2.00	18	2	36	0	0	0	0	0	0	77.21	1389.78		Boehler	04
29	Crease	23.20	2.00	36	2	72	0	0	0	0	0	0	75.22	2707.92		Boehler	04
30	Crease	23.20	2.00	18	2	36	0	0	0	0	0	0	61.22	1101.96		Boehler	04
31	Crease	23.20	2.00	18	1	18	0	0	0	0	0	0	28.14	506.52		Boehler	04
32	Crease	23.20	2.00	18	1	18	0	0	0	0	0	0	27.64	497.52		Boehler	04
33	Crease	23.20	2.00	18	1	18	0	0	0	0	0	0	26.79	482.22		Boehler	04
34	Crease	23.20	2.00	18	1	18	0	0	0	0	0	0	26.29	473.22		Boehler	04
35	Crease	23.20	2.00	18	1	18	0	0	0	0	0	0	24.92	448.56	13366.92	Boehler	04
				900		917		672		582		426			36307.77		