

Rule Processing System ACS 100 for ISO 9000

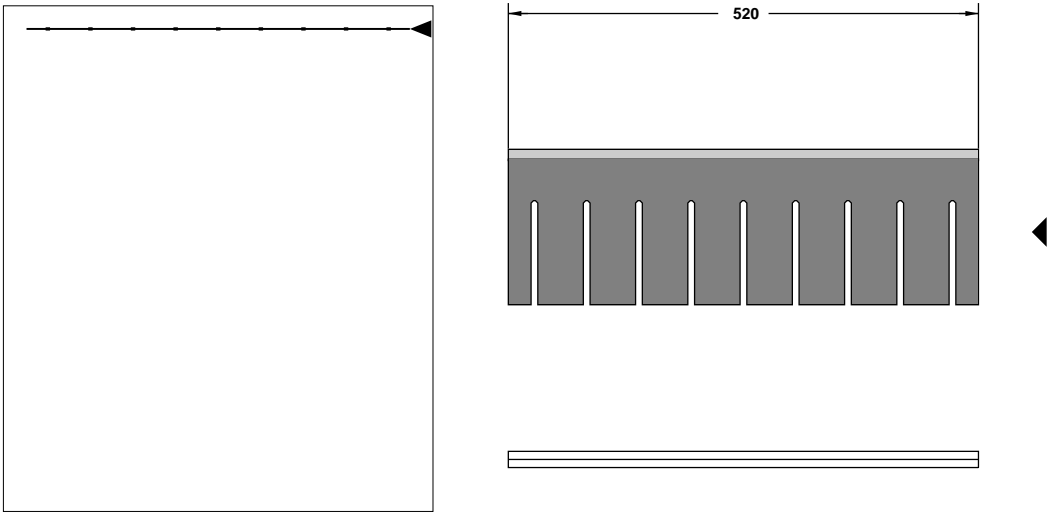

1	Line-No.	Date	27.02.2012	Order-No.		Amount	2	Supplier	
	Path	asercpack/filesW	Author	Yashin A	Height	23.80	Laserpack Fryazino		
	File	g>ECMA_A2220+...	Customer		Manufacturer	Boehler			
	10/15/18		Line type	Cut	Material	UNIVERSAL-T30			
	Sonstiges		Pointage	2.00	Mat. Table	04	Die-Side		

Rule Processing System ACS 100 for ISO 9000

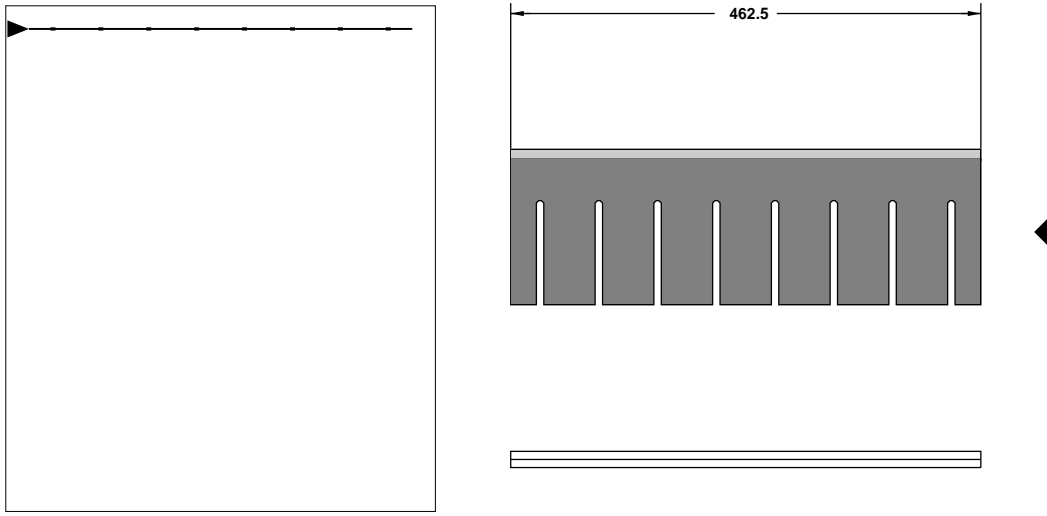

2	Line-No.	Date	27.02.2012	Order-No.		Amount	2	Supplier	
	Path	asercpack/filesW	Author	Yashin A	Height	23.80	Laserpack Fryazino		
	File	g>ECMA_A2220+...	Customer		Manufacturer	Boehler			
	10/15/18		Line type	Cut	Material	UNIVERSAL-T30			
	Sonstiges		Pointage	2.00	Mat. Table	04	Die-Side		

Rule Processing System ACS 100 for ISO 9000

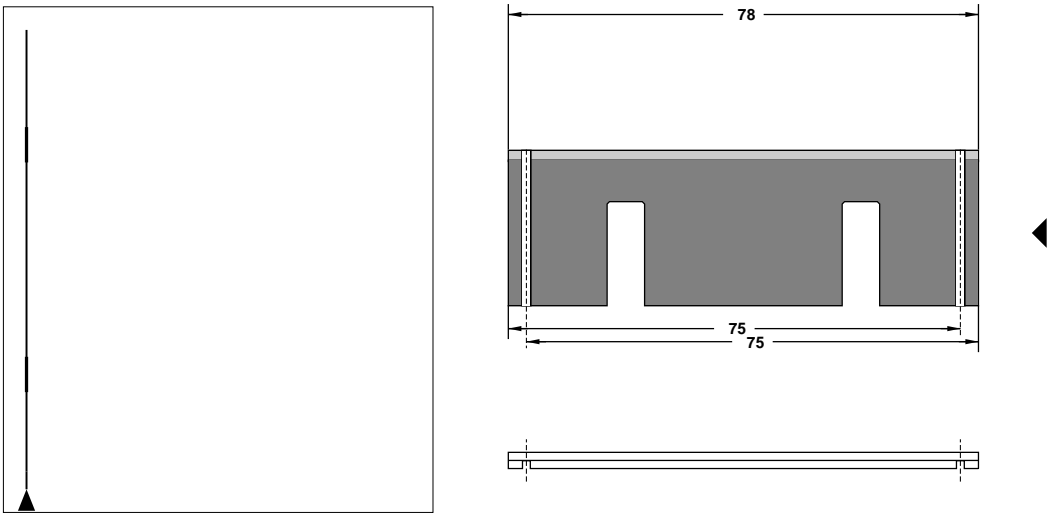

3	Line-No.	Date	27.02.2012	Order-No.		Amount	5	Supplier	
	Path	asercpack/filesW	Author	Yashin A	Height	23.80	Laserpack Fryazino		
	File	g>ECMA_A2220+...	Customer		Manufacturer	Boehler			
	10/15/18		Line type	Cut	Material	UNIVERSAL-T30			
	Sonstiges		Pointage	2.00	Mat. Table	04	Die-Side		

Rule Processing System ACS 100 for ISO 9000

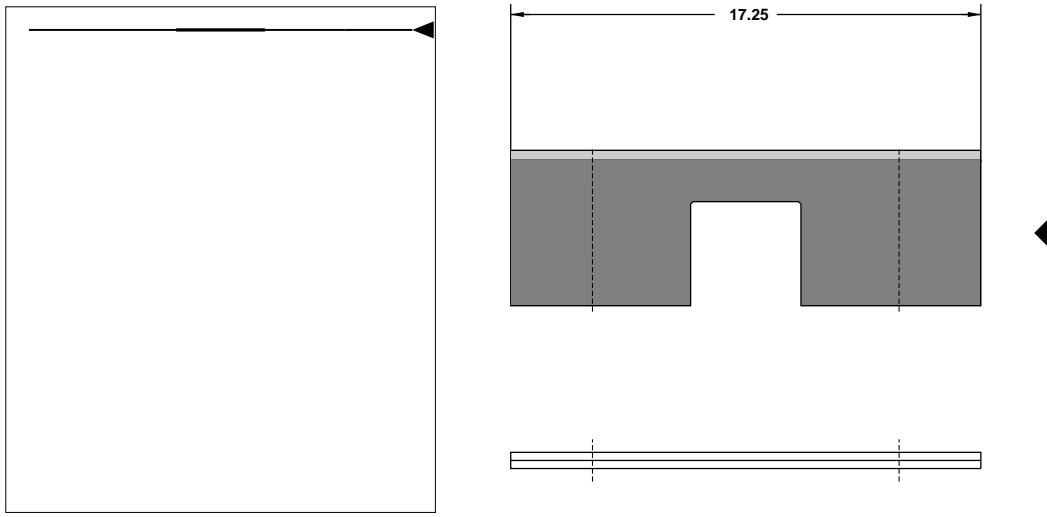

4	Line-No.	Date	27.02.2012	Order-No.		Amount	5	Supplier	
	Path	asercpack/filesW	Author	Yashin A	Height	23.80	Laserpack Fryazino		
	File	g>ECMA_A2220+...	Customer		Manufacturer	Boehler			
	10/15/18		Line type	Cut	Material	UNIVERSAL-T30			
	Sonstiges		Pointage	2.00	Mat. Table	04	Die-Side		

Rule Processing System ACS 100 for ISO 9000

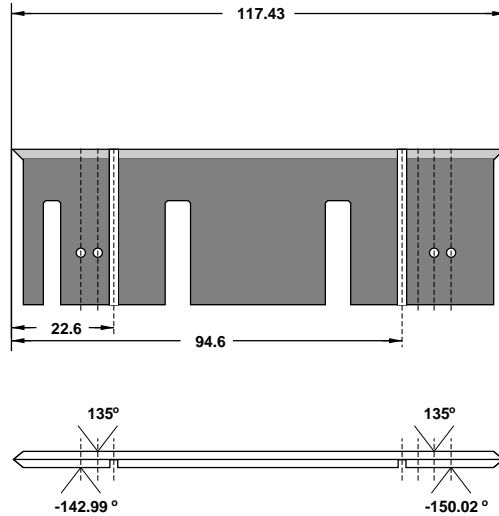
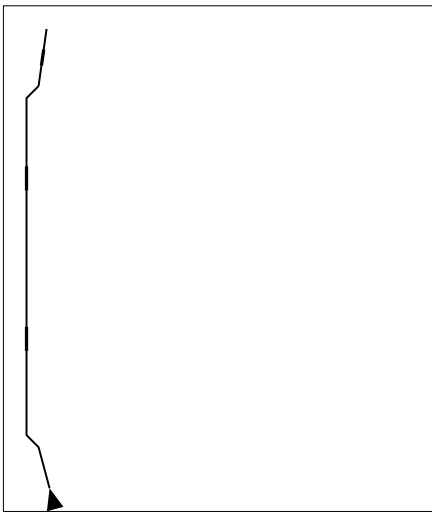

5	Line-No.	Date	27.02.2012	Order-No.		Amount	25	Supplier	
	Path	asercpack/filesW	Author	Yashin A	Height	23.80		Laserpack Fryazino	
	File	g>ECMA_A2220+	Customer		Manufacturer	Boehler			
	10/15/18		Line type	Cut	Material	UNIVERSAL-T30			
	Sonstiges		Pointage	2.00	Mat. Table	04		Die-Side	

Rule Processing System ACS 100 for ISO 9000

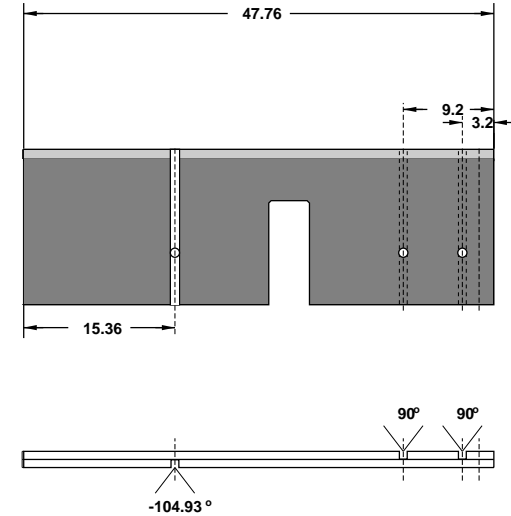
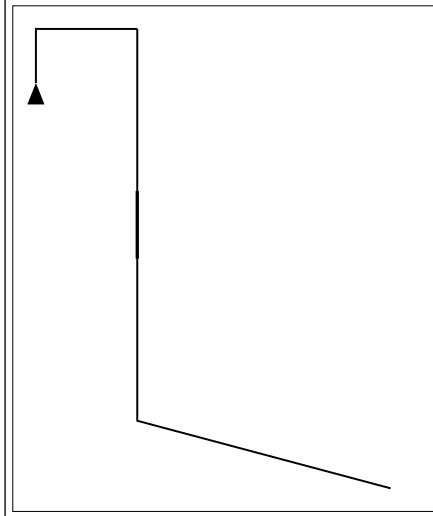

6	Line-No.	Date	27.02.2012	Order-No.		Amount	25	Supplier	
	Path	asercpack/filesW	Author	Yashin A	Height	23.80		Laserpack Fryazino	
	File	g>ECMA_A2220+	Customer		Manufacturer	Boehler			
	10/15/18		Line type	PERFO	Material	UNIVERSAL-T30			
	Sonstiges		Pointage	2.00	Mat. Table	04		Die-Side	

Rule Processing System ACS 100 for ISO 9000

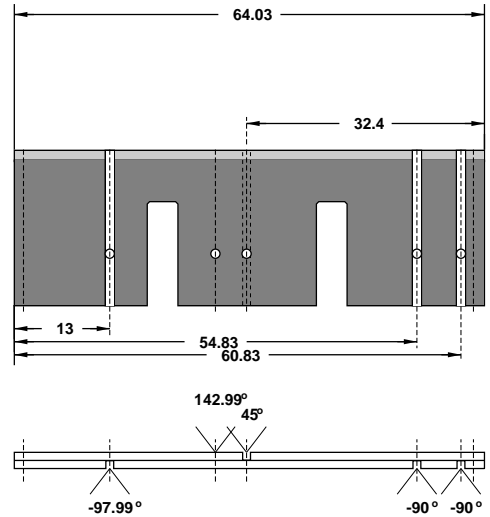
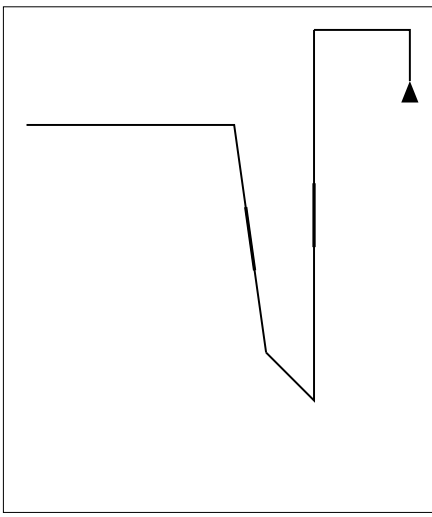

7	Line-No.	Date	27.02.2012	Order-No.		Amount	5	Supplier	
	Path	asercpack/filesW	Author	Yashin A	Height	23.80		Laserpack Fryazino	
	File	g>ECMA_A2220+	Customer		Manufacturer	Boehler			
	10/15/18		Line type	PERFO	Material	UNIVERSAL-T30			
	Sonstiges		Pointage	2.00	Mat. Table	04		Die-Side	

Rule Processing System ACS 100 for ISO 9000

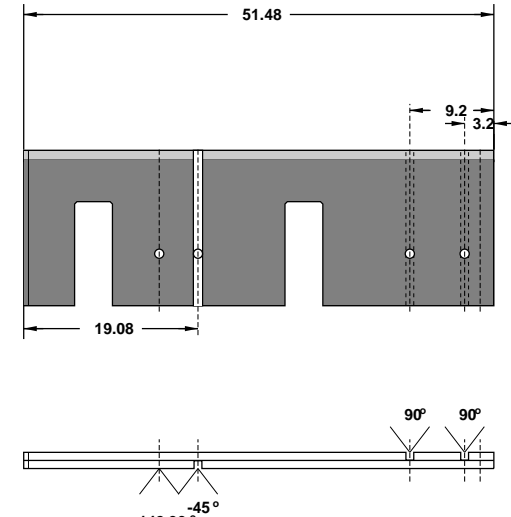
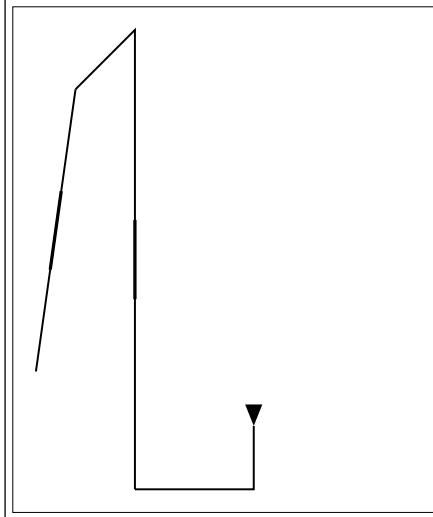

8	Line-No.	Date	27.02.2012	Order-No.		Amount	25	Supplier	
	Path	asercpack/filesW	Author	Yashin A	Height	23.80		Laserpack Fryazino	
	File	g>ECMA_A2220+	Customer		Manufacturer	Boehler			
	10/15/18		Line type	PERFO	Material	UNIVERSAL-T30			
	Sonstiges		Pointage	2.00	Mat. Table	04		Die-Side	

Rule Processing System ACS 100 for ISO 9000

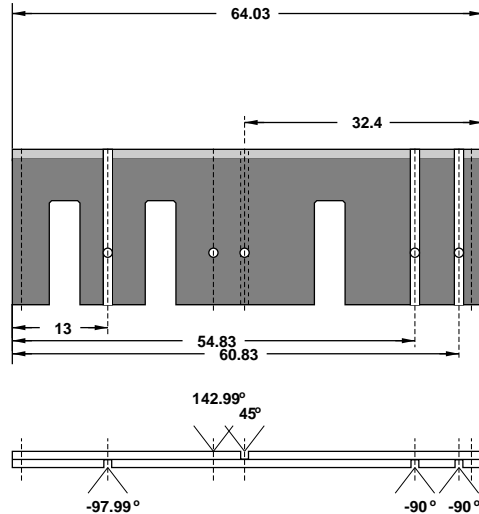
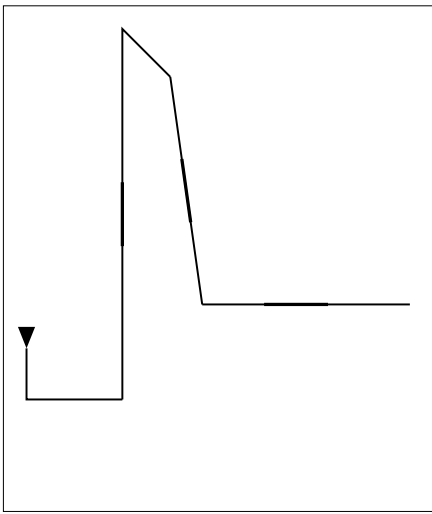

9	Line-No.	Date	27.02.2012	Order-No.		Amount	5	Supplier
	Path	aserpack/filesW	Author	Yashin A	Height	23.80	Laserpack Fryazino	
	File	g>ECMA_A2220+...	Customer		Manufacturer	Boehler		
	10/15/18		Line type	PERFO	Material	UNIVERSAL-T30		
	Sonstiges		Pointage	2.00	Mat. Table	04	Die-Side	

Rule Processing System ACS 100 for ISO 9000

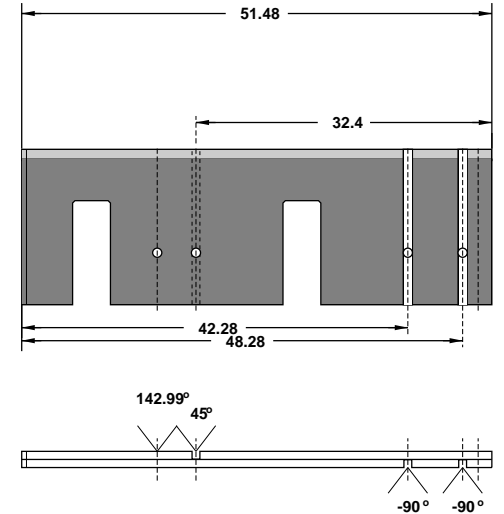
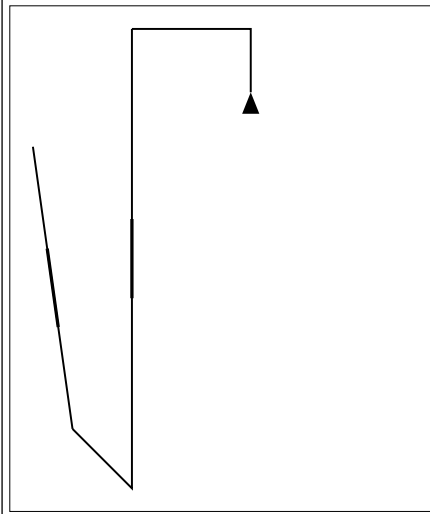

10	Line-No.	Date	27.02.2012	Order-No.		Amount	40	Supplier
	Path	aserpack/filesW	Author	Yashin A	Height	23.80	Laserpack Fryazino	
	File	g>ECMA_A2220+...	Customer		Manufacturer	Boehler		
	10/15/18		Line type	PERFO	Material	UNIVERSAL-T30		
	Sonstiges		Pointage	2.00	Mat. Table	04	Die-Side	

Rule Processing System ACS 100 for ISO 9000

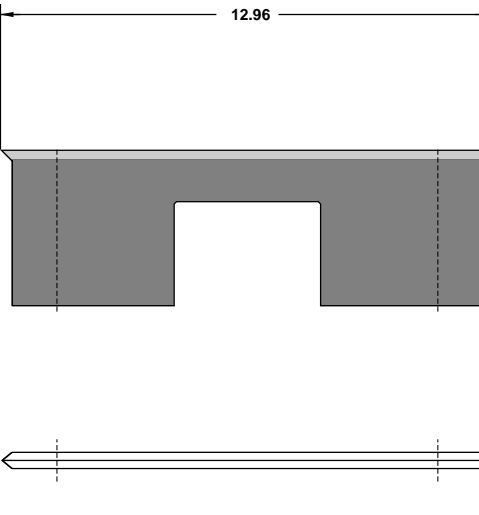
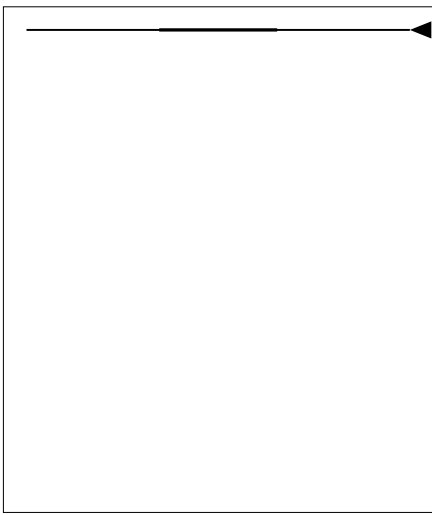

11	Line-No.	Date	27.02.2012	Order-No.		Amount	20	Supplier
	Path	aserpack/filesW	Author	Yashin A	Height	23.80	Laserpack Fryazino	
	File	g>ECMA_A2220+...	Customer		Manufacturer	Boehler		
	10/15/18		Line type	Cut	Material	UNIVERSAL-T30		
	Sonstiges		Pointage	2.00	Mat. Table	04	Die-Side	

Rule Processing System ACS 100 for ISO 9000

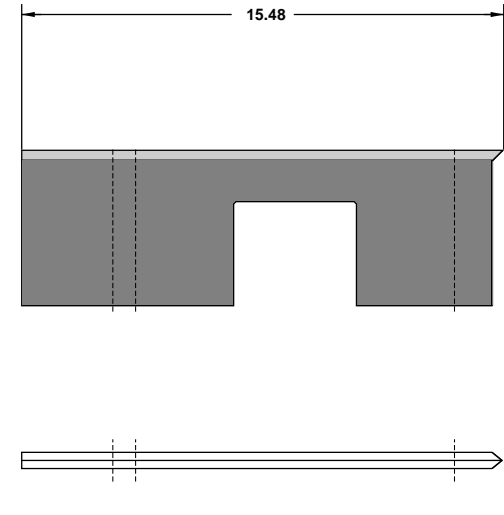
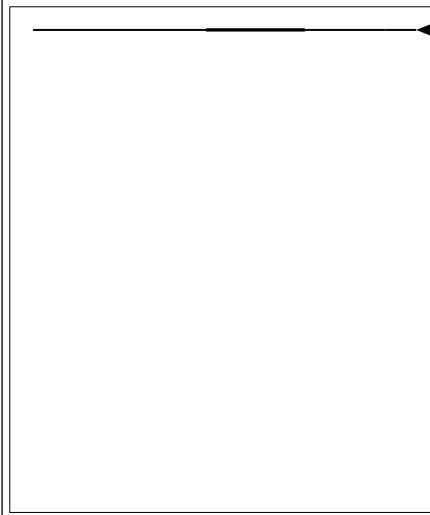

12	Line-No.	Date	27.02.2012	Order-No.		Amount	20	Supplier
	Path	aserpack/filesW	Author	Yashin A	Height	23.80	Laserpack Fryazino	
	File	g>ECMA_A2220+...	Customer		Manufacturer	Boehler		
	10/15/18		Line type	Cut	Material	UNIVERSAL-T30		
	Sonstiges		Pointage	2.00	Mat. Table	04	Die-Side	

Rule Processing System ACS 100 for ISO 9000

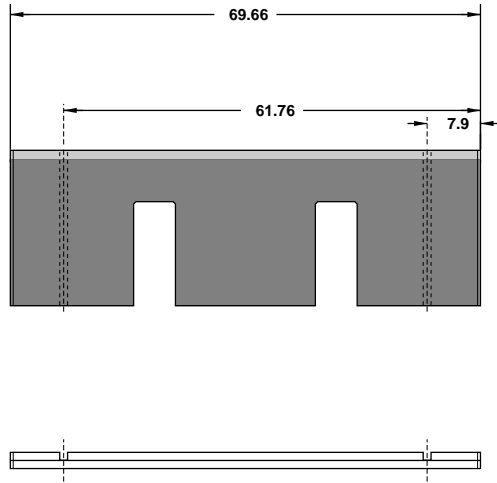
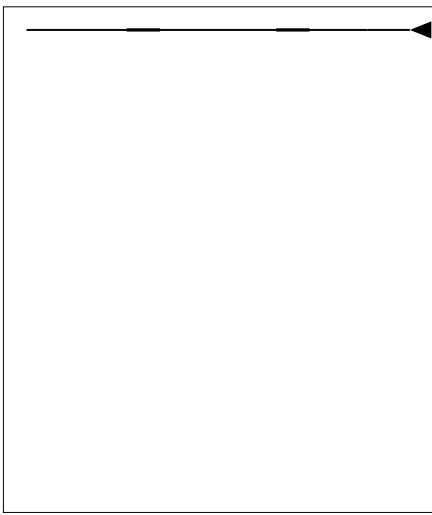

13	Line-No.	Date	27.02.2012	Order-No.		Amount	25	Supplier	
	Path	aserpack/filesW	Author	Yashin A	Height	23.80	Laserpack Fryazino		
	File	g>ECMA_A2220+...	Customer		Manufacturer	Boehler			
	10/15/18		Line type	Cut	Material	UNIVERSAL-T30			
	Sonstiges		Pointage	2.00	Mat. Table	04	Die-Side		

Rule Processing System ACS 100 for ISO 9000

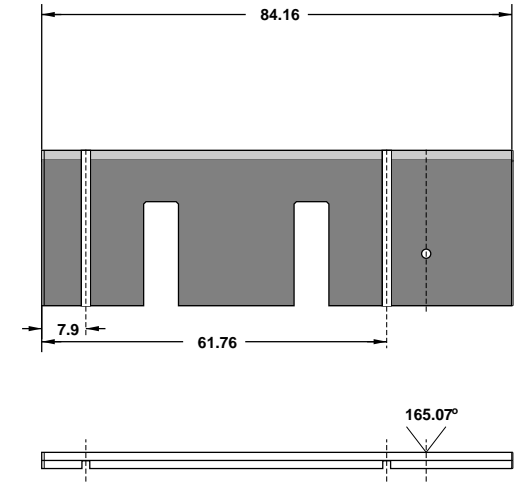
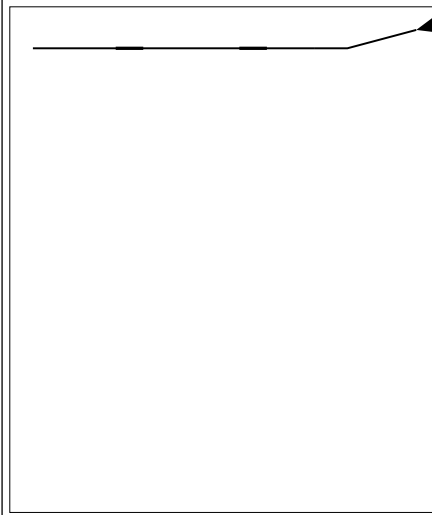

14	Line-No.	Date	27.02.2012	Order-No.		Amount	25	Supplier	
	Path	aserpack/filesW	Author	Yashin A	Height	23.80	Laserpack Fryazino		
	File	g>ECMA_A2220+...	Customer		Manufacturer	Boehler			
	10/15/18		Line type	Cut	Material	UNIVERSAL-T30			
	Sonstiges		Pointage	2.00	Mat. Table	04	Die-Side		

Rule Processing System ACS 100 for ISO 9000

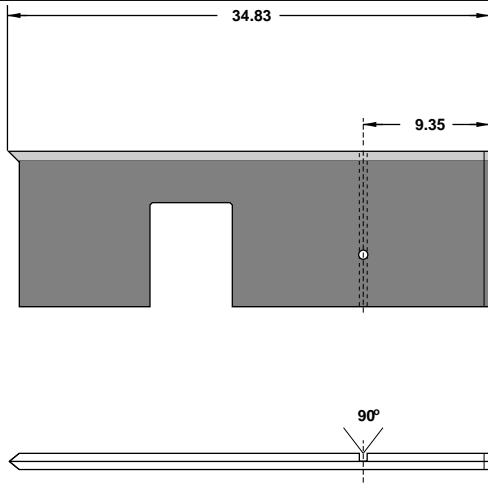
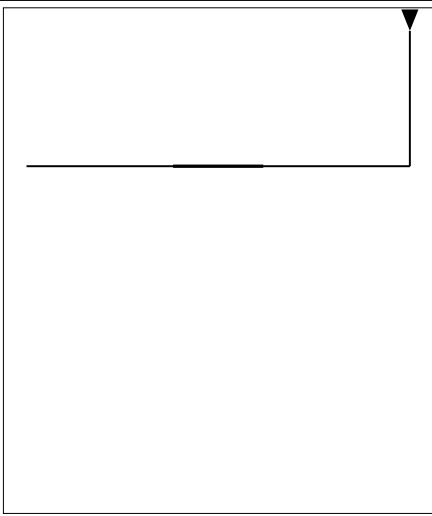

15	Line-No.	Date	27.02.2012	Order-No.		Amount	50	Supplier	
	Path	aserpack/filesW	Author	Yashin A	Height	23.80	Laserpack Fryazino		
	File	g>ECMA_A2220+...	Customer		Manufacturer	Boehler			
	10/15/18		Line type	Cut	Material	UNIVERSAL-T30			
	Sonstiges		Pointage	2.00	Mat. Table	04	Die-Side		

Rule Processing System ACS 100 for ISO 9000

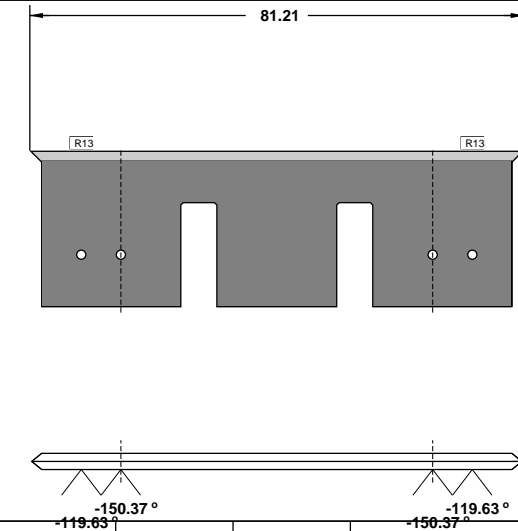
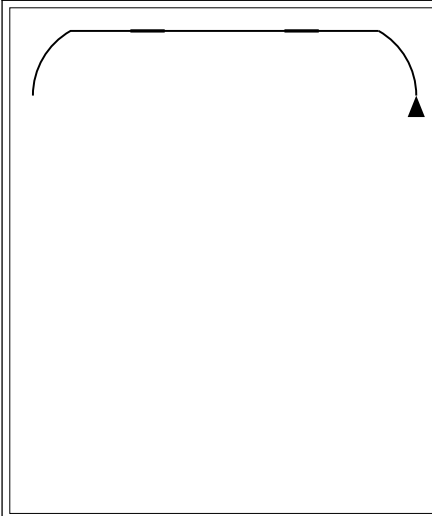

16	Line-No.	Date	27.02.2012	Order-No.		Amount	10	Supplier	
	Path	aserpack/filesW	Author	Yashin A	Height	23.80	Laserpack Fryazino		
	File	g>ECMA_A2220+...	Customer		Manufacturer	Boehler			
	10/15/18		Line type	Cut	Material	UNIVERSAL-T30			
	Sonstiges		Pointage	2.00	Mat. Table	04	Die-Side		

Rule Processing System ACS 100 for ISO 9000

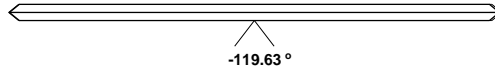
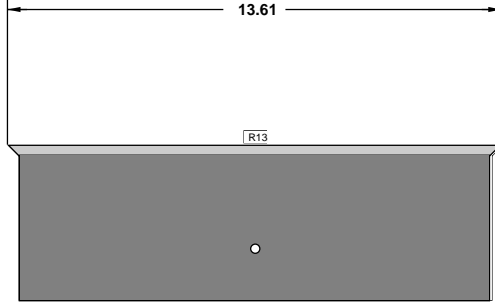
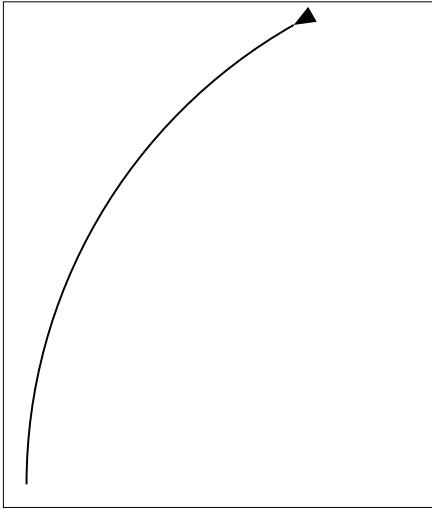

17	Line-No.	Date	27.02.2012	Order-No.		Amount	80	Supplier	
	Path	aserpack/filesW	Author	Yashin A	Height	23.80	Laserpack Fryazino		
	File	g>ECMA_A2220+...	Customer		Manufacturer	Boehler			
	10/15/18		Line type	Cut	Material	UNIVERSAL-T30			
	Sonstiges		Pointage	2.00	Mat. Table	04	Die-Side		

Rule Processing System ACS 100 for ISO 9000

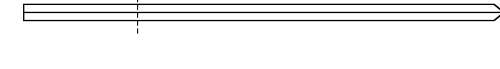
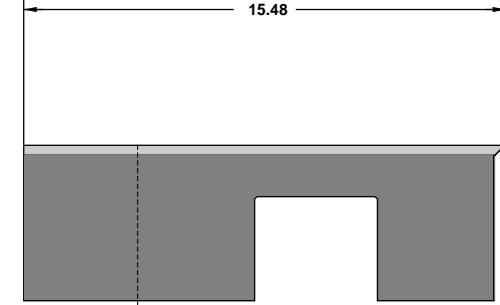

18	Line-No.	Date	27.02.2012	Order-No.		Amount	5	Supplier	
	Path	aserpack/filesW	Author	Yashin A	Height	23.80	Laserpack Fryazino		
	File	g>ECMA_A2220+...	Customer		Manufacturer	Boehler			
	10/15/18		Line type	Cut	Material	UNIVERSAL-T30			
	Sonstiges		Pointage	2.00	Mat. Table	04	Die-Side		

Rule Processing System ACS 100 for ISO 9000

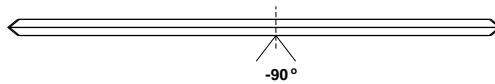
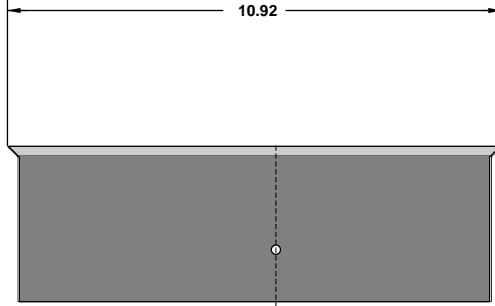
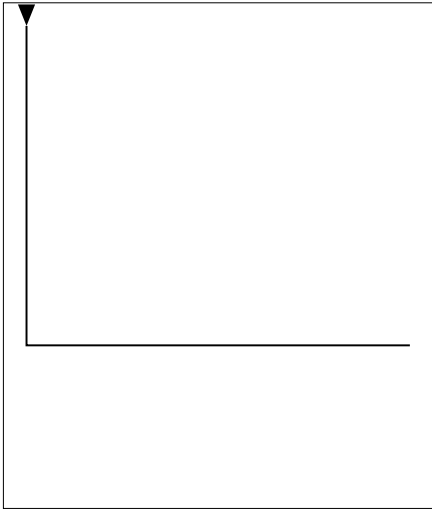

19	Line-No.	Date	27.02.2012	Order-No.		Amount	5	Supplier	
	Path	aserpack/filesW	Author	Yashin A	Height	23.80	Laserpack Fryazino		
	File	g>ECMA_A2220+...	Customer		Manufacturer	Boehler			
	10/15/18		Line type	Cut	Material	UNIVERSAL-T30			
	Sonstiges		Pointage	2.00	Mat. Table	04	Die-Side		

Rule Processing System ACS 100 for ISO 9000

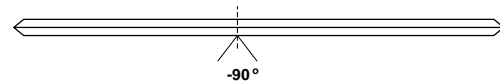
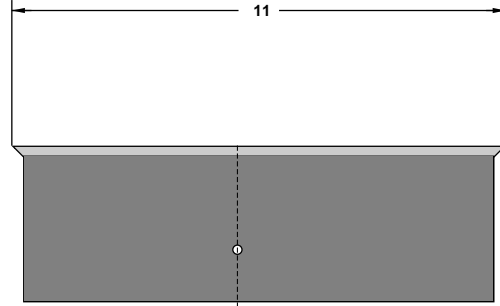
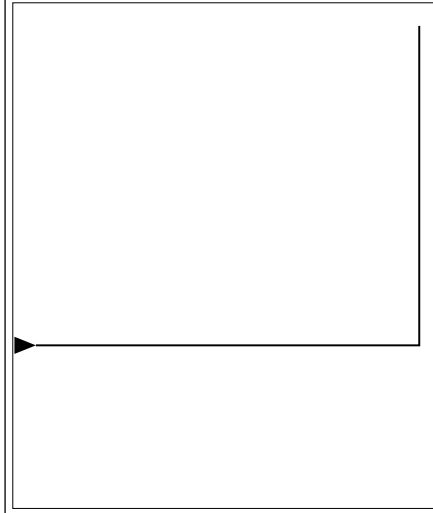

20	Line-No.	Date	27.02.2012	Order-No.		Amount	5	Supplier	
	Path	aserpack/filesW	Author	Yashin A	Height	23.80	Laserpack Fryazino		
	File	g>ECMA_A2220+...	Customer		Manufacturer	Boehler			
	10/15/18		Line type	Cut	Material	UNIVERSAL-T30			
	Sonstiges		Pointage	2.00	Mat. Table	04	Die-Side		

Rule Processing System ACS 100 for ISO 9000

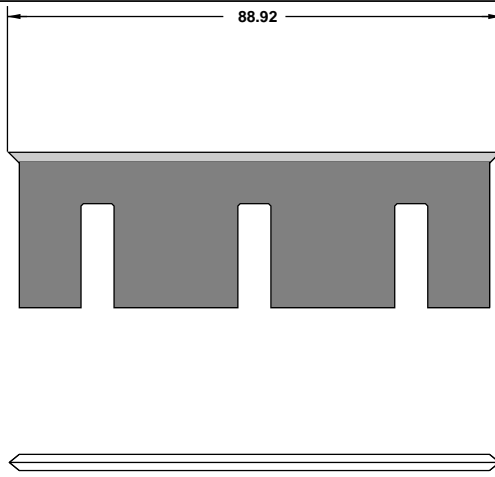
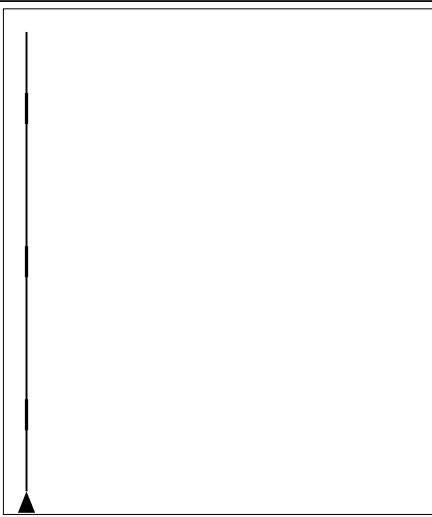

21	Line-No.	Date	27.02.2012	Order-No.		Amount	5	Supplier	
	Path	aserpack/filesW	Author	Yashin A	Height	23.80	Laserpack Fryazino		
	File	g>ECMA_A2220+...	Customer		Manufacturer	Boehler			
	10/15/18		Line type	Cut	Material	UNIVERSAL-T30			
	Sonstiges		Pointage	2.00	Mat. Table	04	Die-Side		

Rule Processing System ACS 100 for ISO 9000

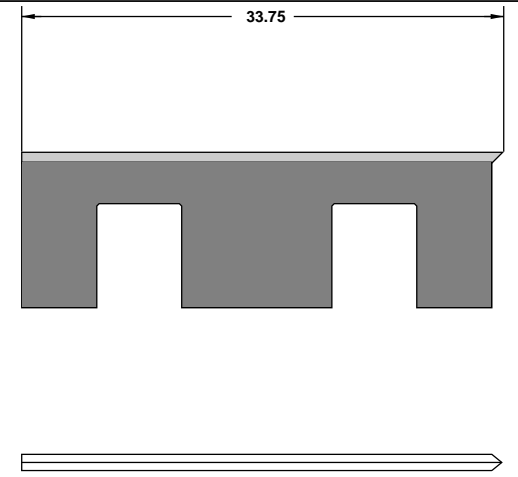
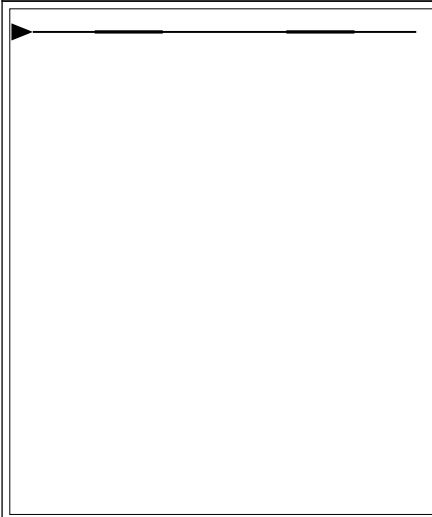

22	Line-No.	Date	27.02.2012	Order-No.		Amount	4	Supplier	
	Path	aserpack/filesW	Author	Yashin A	Height	23.80	Laserpack Fryazino		
	File	g>ECMA_A2220+...	Customer		Manufacturer	Boehler			
	10/15/18		Line type	Cut	Material	UNIVERSAL-T30			
	Sonstiges		Pointage	2.00	Mat. Table	04	Die-Side		

Rule Processing System ACS 100 for ISO 9000

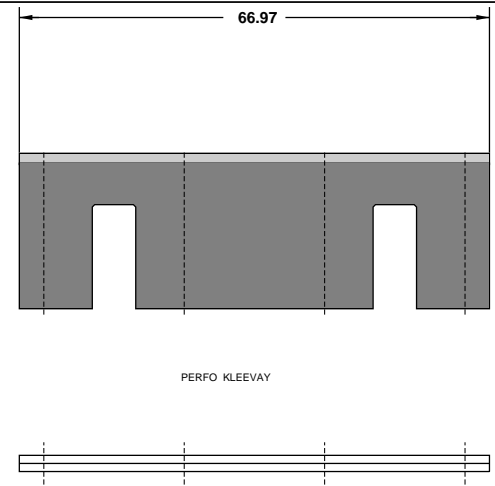
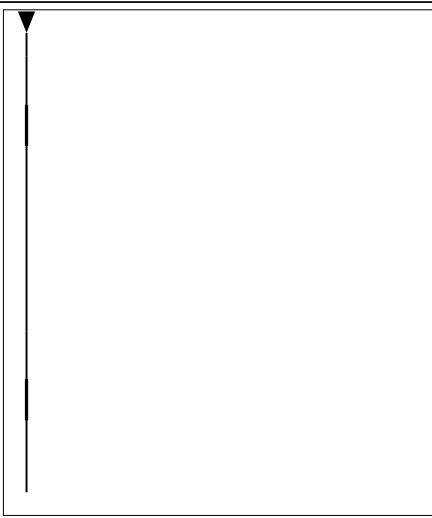

23	Line-No.	Date	27.02.2012	Order-No.		Amount	25	Supplier	
	Path	aserpack/filesW	Author	Yashin A	Height	23.80	Laserpack Fryazino		
	File	g>ECMA_A2220+...	Customer		Manufacturer	Boehler			
	10/15/18		Line type	PERFO	Material	UNIVERSAL-T30			
	Sonstiges		Pointage	2.00	Mat. Table	04	Die-Side		

Rule Processing System ACS 100 for ISO 9000

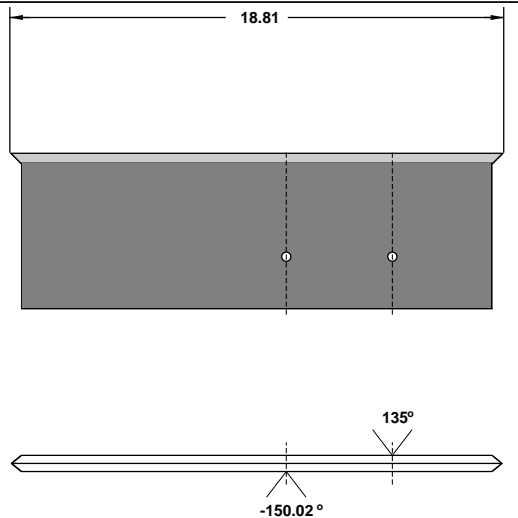
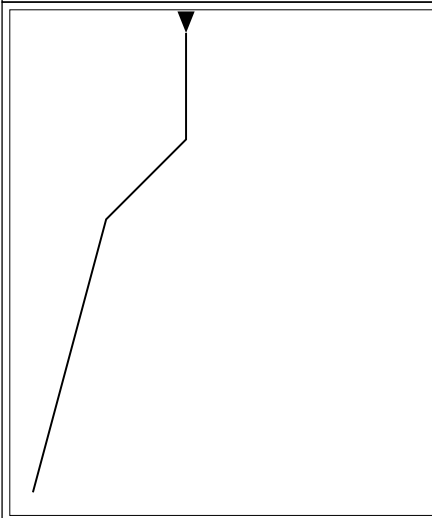

24	Line-No.	Date	27.02.2012	Order-No.		Amount	50	Supplier	
	Path	aserpack/filesW	Author	Yashin A	Height	23.80	Laserpack Fryazino		
	File	g>ECMA_A2220+...	Customer		Manufacturer	Boehler			
	10/15/18		Line type	Cut	Material	UNIVERSAL-T30			
	Sonstiges		Pointage	2.00	Mat. Table	04	Die-Side		

Rule Processing System ACS 100 for ISO 9000

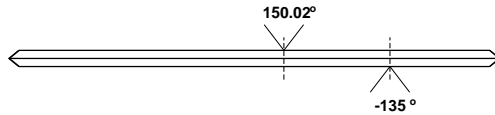
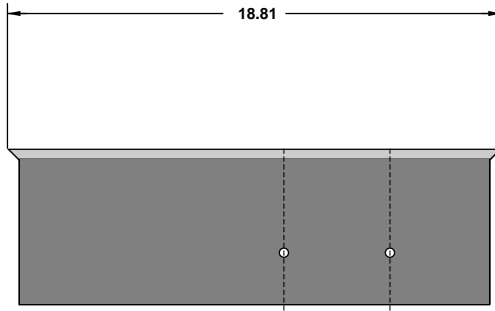
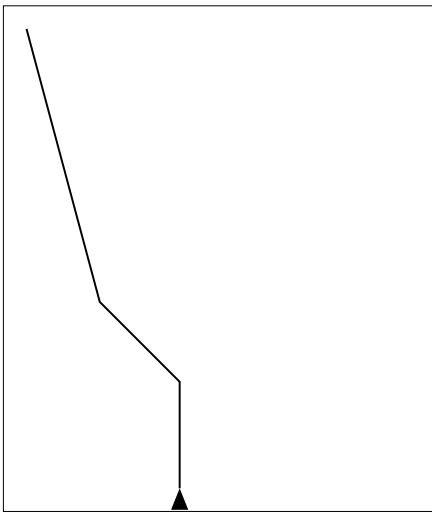

Line-No.	Date	27.02.2012	Order-No.		Amount	25	Supplier
25	Path	aserpack/filesW	Author	Yashin A	Height	23.80	Laserpack Fryazino
	File	g>ECMA_A2220+...	Customer		Manufacturer	Boehler	
	10/15/18		Line type	Cut	Material	UNIVERSAL-T30	
	Sonstiges		Pointage	2.00	Mat. Table	04	
					Die-Side		

Rule Processing System ACS 100 for ISO 9000

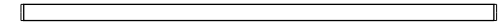
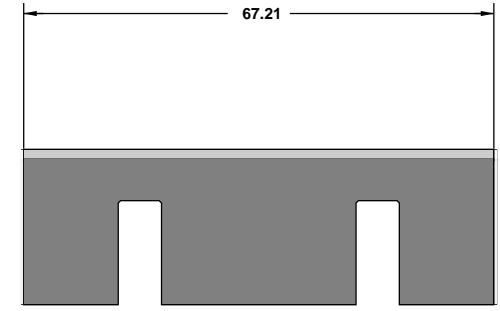

Line-No.	Date	27.02.2012	Order-No.		Amount	25	Supplier
26	Path	aserpack/filesW	Author	Yashin A	Height	23.30	Laserpack Fryazino
	File	g>ECMA_A2220+...	Customer		Manufacturer	Boehler	
	10/15/18		Line type	Crease	Material	UNIVERSAL-T30	
	Sonstiges		Pointage	2.00	Mat. Table	04	
					Die-Side		

Rule Processing System ACS 100 for ISO 9000

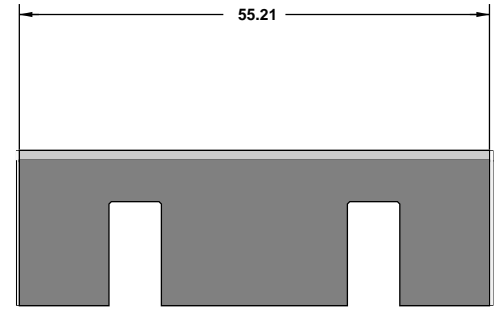
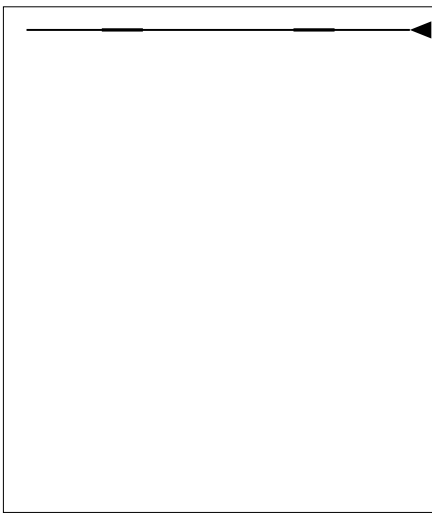

Line-No.	Date	27.02.2012	Order-No.		Amount	50	Supplier
27	Path	aserpack/filesW	Author	Yashin A	Height	23.30	Laserpack Fryazino
	File	g>ECMA_A2220+...	Customer		Manufacturer	Boehler	
	10/15/18		Line type	Crease	Material	UNIVERSAL-T30	
	Sonstiges		Pointage	2.00	Mat. Table	04	
					Die-Side		

Rule Processing System ACS 100 for ISO 9000

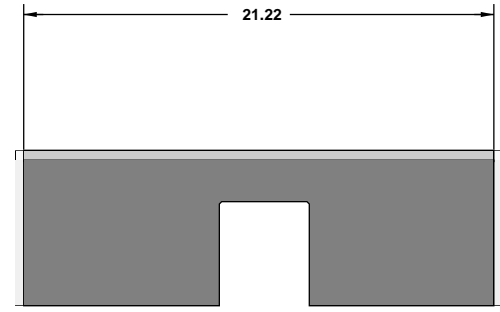

Line-No.	Date	27.02.2012	Order-No.		Amount	75	Supplier
28	Path	aserpack/filesW	Author	Yashin A	Height	23.30	Laserpack Fryazino
	File	g>ECMA_A2220+...	Customer		Manufacturer	Boehler	
	10/15/18		Line type	Crease	Material	UNIVERSAL-T30	
	Sonstiges		Pointage	2.00	Mat. Table	04	
					Die-Side		

Rule Processing System ACS 100 for ISO 9000

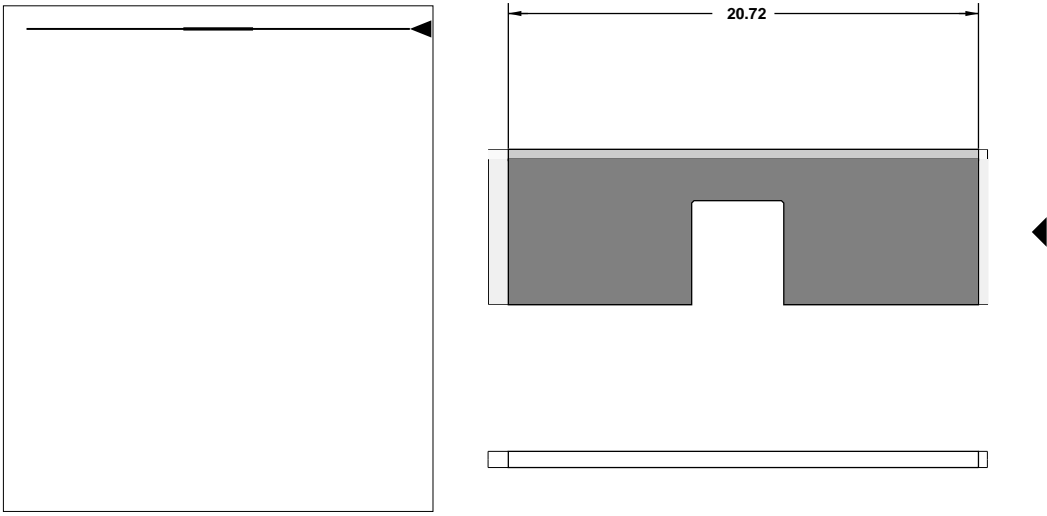

29	Line-No.	Date	27.02.2012	Order-No.		Amount	25	Supplier	
	Path	aserpack/filesW	Author	Yashin A	Height	23.30	Laserpack Fryazino		
	File	g>ECMA_A2220+...	Customer		Manufacturer	Boehler			
	10/15/18		Line type	Crease	Material	UNIVERSAL-T30			
	Sonstiges		Pointage	2.00	Mat. Table	04	Die-Side		

Rule Processing System ACS 100 for ISO 9000

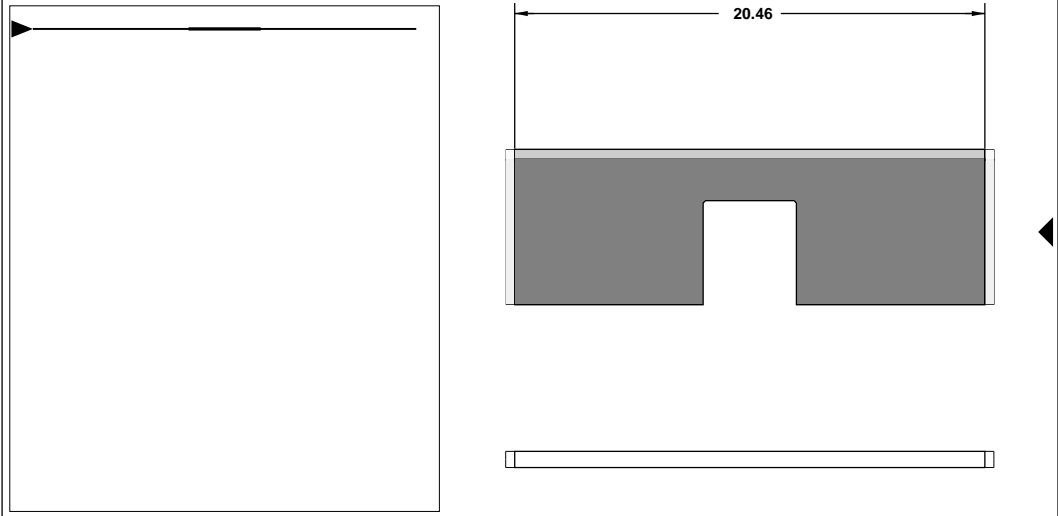

30	Line-No.	Date	27.02.2012	Order-No.		Amount	50	Supplier	
	Path	aserpack/filesW	Author	Yashin A	Height	23.30	Laserpack Fryazino		
	File	g>ECMA_A2220+...	Customer		Manufacturer	Boehler			
	10/15/18		Line type	Crease	Material	UNIVERSAL-T30			
	Sonstiges		Pointage	2.00	Mat. Table	04	Die-Side		

Rule Processing System ACS 100 for ISO 9000

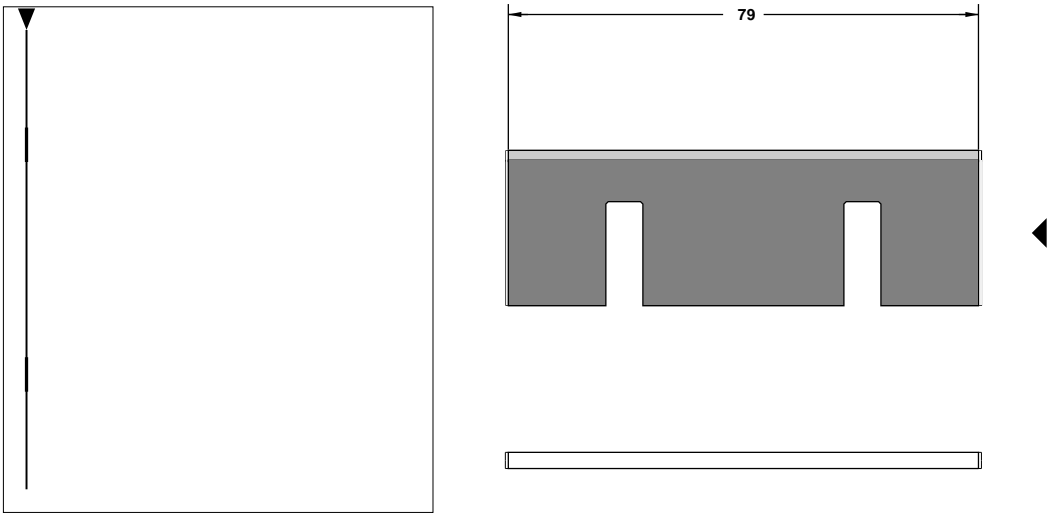

31	Line-No.	Date	27.02.2012	Order-No.		Amount	25	Supplier	
	Path	aserpack/filesW	Author	Yashin A	Height	23.30	Laserpack Fryazino		
	File	g>ECMA_A2220+...	Customer		Manufacturer	Boehler			
	10/15/18		Line type	Crease	Material	UNIVERSAL-T30			
	Sonstiges		Pointage	2.00	Mat. Table	04	Die-Side		

Rule Processing System ACS 100 for ISO 9000

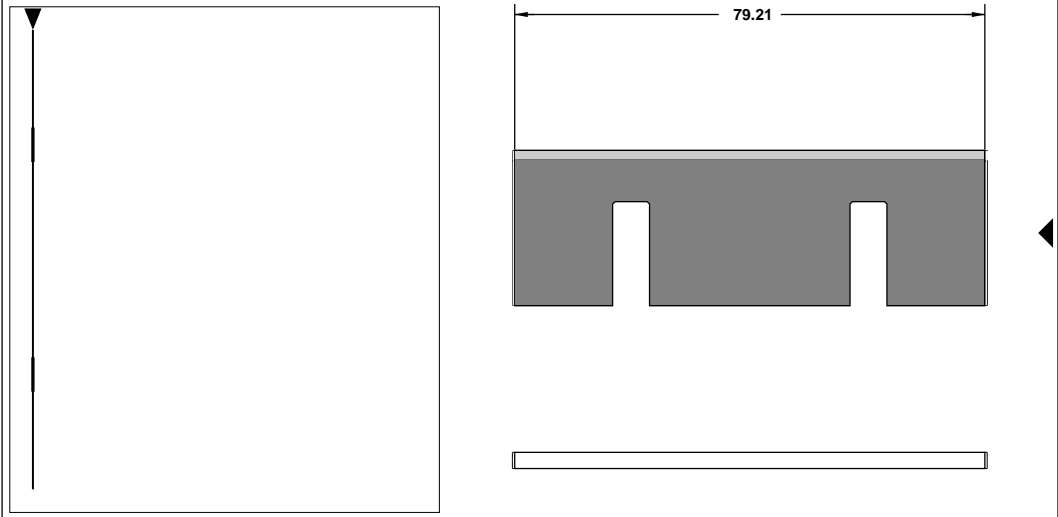

32	Line-No.	Date	27.02.2012	Order-No.		Amount	75	Supplier	
	Path	aserpack/filesW	Author	Yashin A	Height	23.30	Laserpack Fryazino		
	File	g>ECMA_A2220+...	Customer		Manufacturer	Boehler			
	10/15/18		Line type	Crease	Material	UNIVERSAL-T30			
	Sonstiges		Pointage	2.00	Mat. Table	04	Die-Side		

complete list

Date	File	Order-No.	Author	Customer	Up
27.02.2012	g>ECMA_A2220+.dds		Yashin A		1

No.	Line type	Height	Point.	Amount	Bridges		BEMDMARK		KBends		Broaching		Length	Sum	Total	Manufacturer	Mat. Table
					Sing.	Sum	Sing.	Sum	Sing.	Sum	Sing.	Sum					
1	Cut	23.80	2.00	2	9	18	0	0	0	0	0	0	520.00	1040.00		Boehler	04
2	Cut	23.80	2.00	2	8	16	0	0	0	0	0	0	462.50	925.00		Boehler	04
3	Cut	23.80	2.00	5	2	10	0	0	0	0	2	10	78.00	390.00		Boehler	04
4	Cut	23.80	2.00	5	1	5	0	0	0	0	0	0	17.25	86.25		Boehler	04
5	Cut	23.80	2.00	25	3	75	4	100	4	100	2	50	117.43	2935.75	5377.00	Boehler	04
6	PERFO	23.80	2.00	25	1	25	3	75	3	75	3	75	47.76	1194.00		Boehler	04
7	PERFO	23.80	2.00	5	2	10	5	25	5	25	4	20	64.03	320.15		Boehler	04
8	PERFO	23.80	2.00	25	2	50	4	100	4	100	3	75	51.48	1287.00		Boehler	04
9	PERFO	23.80	2.00	5	3	15	5	25	5	25	4	20	64.03	320.15		Boehler	04
10	PERFO	23.80	2.00	40	2	80	4	160	4	160	3	120	51.48	2059.20	5180.50	Boehler	04
11	Cut	23.80	2.00	20	1	20	0	0	0	0	0	0	12.96	259.20		Boehler	04
12	Cut	23.80	2.00	20	1	20	0	0	0	0	0	0	15.48	309.60		Boehler	04
13	Cut	23.80	2.00	25	2	50	0	0	0	0	2	50	69.66	1741.50		Boehler	04
14	Cut	23.80	2.00	25	2	50	1	25	1	25	2	50	84.16	2104.00		Boehler	04
15	Cut	23.80	2.00	50	1	50	1	50	1	50	1	50	34.83	1741.50		Boehler	04
16	Cut	23.80	2.00	10	2	20	4	40	2	20	0	0	81.21	812.10		Boehler	04
17	Cut	23.80	2.00	80	0	0	1	80	0	0	0	0	13.61	1088.80		Boehler	04
18	Cut	23.80	2.00	5	1	5	0	0	0	0	0	0	15.48	77.40		Boehler	04
19	Cut	23.80	2.00	5	0	0	1	5	1	5	0	0	10.92	54.60		Boehler	04
20	Cut	23.80	2.00	5	0	0	1	5	1	5	0	0	11.00	55.00		Boehler	04

complete list

Date	File	Order-No.	Author	Customer	Up
27.02.2012	g>ECMA_A2220+.dds		Yashin A		1

No.	Line type	Height	Point.	Amount	Bridges		BEMDMARK		KBends		Broaching		Length	Sum	Total	Manufacturer	Mat. Table
					Sing.	Sum	Sing.	Sum	Sing.	Sum	Sing.	Sum					
21	Cut	23.80	2.00	5	3	15	0	0	0	0	0	0	88.92	444.60		Boehler	04
22	Cut	23.80	2.00	4	2	8	0	0	0	0	0	0	33.75	135.00	8823.30	Boehler	04
23	PERFO	23.80	2.00	25	2	50	0	0	0	0	0	0	66.97	1674.25	1674.25	Boehler	04
24	Cut	23.80	2.00	50	0	0	2	100	2	100	0	0	18.81	940.50		Boehler	04
25	Cut	23.80	2.00	25	0	0	2	50	2	50	0	0	18.81	470.25	1410.75	Boehler	04
26	Crease	23.30	2.00	25	2	50	0	0	0	0	0	0	67.21	1680.25		Boehler	04
27	Crease	23.30	2.00	50	2	100	0	0	0	0	0	0	55.21	2760.50		Boehler	04
28	Crease	23.30	2.00	75	1	75	0	0	0	0	0	0	21.22	1591.50		Boehler	04
29	Crease	23.30	2.00	25	1	25	0	0	0	0	0	0	20.72	518.00		Boehler	04
30	Crease	23.30	2.00	50	1	50	0	0	0	0	0	0	20.46	1023.00		Boehler	04
31	Crease	23.30	2.00	25	2	50	0	0	0	0	0	0	79.00	1975.00		Boehler	04
32	Crease	23.30	2.00	75	2	150	0	0	0	0	0	0	79.21	5940.75	15489.00	Boehler	04
					818	1092		840		740		520			37954.80		